

HEART OF ILLINOIS CLUSTER DOG SHOWS

MAY 22-25, 2026



Chicago Bulldog Club, Inc.

Concurrent Specialties see [pages 39 & 40](#)

**SEE PAGE 17 FOR SPECIAL REDUCED HOTEL RATES
OFA EYE CLINIC AND CARDIAC CLINIC**

4-6 Month Beginner Puppy Competition SAT & SUN	AKC National Owner-Handled Series All 4 Days
FREE Junior Showmanship Entries	FastCAT SAT & SUN

FOUR SHOWS • ONE LOCATION

NOTICE TO EXHIBITORS!!!

Best Practices Guidelines: REGARDING COVID-19: The Heart of Illinois Cluster Dog Shows will abide by the State of Illinois, local and facility guidelines in effect May 21-25, 2026. A risk of exposure to communicable disease exists in any public place. Event Attendees assume all risks related to exposure to communicable diseases. It is incumbent upon event attendees to follow guidelines to prevent spread. Suggested Best Practices for the well-being of Dog Sport Participants please see <http://www.akc.otg/press-center/covid-19updates-from-the-american-kennel-club/> Conditions and regulations change frequently so please check this IL site for up to date information:
<https://pcchd.org/DocumentCenter/View/1364/CDC-Quarentine-Guidance-Dec-2020-PDF> or the McLean County site: <https://health.mcleancountyil.gov>

Onsite AED is located at the Superintendent's desk.

Stop by our Annual Raffle & Silent Auction



Tickets will be available:

Friday 8am-4pm

Saturday 8am-4pm

Sunday 8am-11:30am



Raffle winners will be drawn Sunday at 1pm.

Any prizes left unclaimed will be re-drawn on Monday at 9am.

Silent Auction winners will be announced Sunday at 2pm.

Thank you for supporting the HOI Cluster Dog Shows!

OFA Eye Examinations by Dr. Erica Tolar DVM,

DACVO

Saturday, MAY 23, 2026 9 AM-4 PM (last dilation at 3:30PM)

\$50 per dog, first come first served

NO preregistration required

Cash/Check only

Bring your dogs information with you!

Online form for OFA if you choose to fill this out instead of the hard copy provided at the show – link provided below

OFA online paperwork: <https://online.ofa.org/login/>

****If you do an online form through OFA you will need to print the form and bring it with you****

Event: Heart of Illinois Cluster Dog Shows

Location: Interstate Center 1106 Interstate Dr, Bloomington, IL
61705

Contact information for Dr. Erica Tolar

bluegrassvetvision@gmail.com



**AMERICAN
KENNEL CLUB®**

CERTIFICATION

Permission has been granted by the American Kennel Club for the holding of this event under the American Kennel Club rules and regulations.

SHEILA H. GOFFE, Executive Secretary

HOI Cluster Cardiac Screening Clinic 2026

Sponsored by: Illinois Valley Kennel Club of Peoria, INC
Echocardiogram w/ Auscultation (\$310.00 / Dog)
Auscultation Only (\$110.00 / Dog)

Cecilia Marshall, DVM, DACVIM (Cardiology)
Veterinary Specialty Services in Manchester, MO 63021

Located at the Interstate Center, Bloomington, IL in the Mini Expo building;
May 24th, 2026

Pre-Registration is strongly encouraged; closes **May 8th, 2026**
Walk-Ins welcome

Please contact Sandy Baxter-Carr with any questions.

Call/Text: 309-258-5981

Email: snowbirdsdemipointe@gmail.com

Mail the form below to Sandy Baxter-Carr: 112 Loren St. Washington, IL 61571

Postmarked no later than May 8th, 2026

Pre-Reg: Checks or Money Orders Only
Walk-ins: Cash or Checks

Make checks Payable to IVKC of Peoria, INC.

Scheduling will be done in the order received and will be available 2-5 days after show closing.

Name _____

Email _____

Phone _____

Breed(s) _____

Entered in Competition? (YES) (NO)

Specific time request(s) _____

Echocardiogram with Auscultation:

Number of Dogs _____ x \$310.00 = _____

Auscultation Only: Number of Dogs _____ x \$110.00 = _____

Note: There will be NO Refunds for missed or cancelled appointments.

Checks that decline will have an added fee of \$35.

**Please bring your dogs
registration # as it will
be needed to complete
OFA paperwork.**

Interstate Center



1106 Interstate Dr. Bloomington, IL 61705
www.interstatecenter.com

NOTICE TO EXHIBITORS!!

THIS IS A SELF CLEANING EVENT.

EXHIBITORS ARE RESPONSIBLE FOR ALL

CLEAN UP BOTH IN AND OUTSIDE THE RINGS.

CLEAN UP MATERIALS ARE AVAILABLE AT DESIGNATED STATIONS.

BOTH BUILDINGS ARE FULLY AIR-CONDITIONED.

**AN ENCLOSED WALKWAY WILL CONNECT THE 2 BUILDINGS,
PERMITTING EASY ACCESS REGARDLESS OF THE WEATHER.**

NEW EXHIBITOR BRIEFING SATURDAY

Check Judging Program for time & location.

Premium Lists

BULLDOGS ARE LIMITED TO 100 ENTRIES AT THE CONCURRENT SPECIALTY & THE ALL BREED SHOW THE DAY OF THE CONCURRENT SPECIALTY.

ENTRIES CLOSE WEDNESDAY NOON, CDT MAY 6, 2026, or when the limits have been reached, if reached prior to this date at Superintendent's Office. After which time entries cannot be accepted, canceled, altered or substituted except as provided for in Chapter 11, Section 6 of the Dog Show Rules.

ALL BREED DOG SHOWS - UNBENCHED - INDOORS ILLINOIS VALLEY KENNEL CLUB OF PEORIA, INC.

Member of the American Kennel Club

Friday, May 22, 2026 - 2026060901

Sunday, May 24, 2026 - 2026060902

4-6 Month Beginner Puppy Competition - 2026060903

137TH CONCURRENT SPECIALTY

CHICAGO BULLDOG CLUB, INC. - 2026025302

DESIGNATED SPECIALTY SHOWS • HEART OF ILLINOIS BRITTANY CLUB - 2026147703

PRAIRIELAND STANDARD SCHNAUZER CLUB OF CENTRAL ILLINOIS - 2026567401

NORTH CENTRAL ILLINOIS PEKINGESE CLUB - 2026153502

CORN BELT KENNEL CLUB, INC.

Member of the American Kennel Club

Saturday, May 23, 2026 - 2026100401

4-6 Month Beginner Puppy Competition - 2026100402

136TH CONCURRENT SPECIALTY

CHICAGO BULLDOG CLUB, INC. - 2026025301

DESIGNATED SPECIALTY SHOWS

MINIATURE BULL TERRIER CLUB OF AMERICA - 2026469809

NORTH CENTRAL ILLINOIS PEKINGESE CLUB - 2026153501

Monday, May 25, 2026 - 2026100407

SUPPORTED ENTRIES

HEART OF ILLINOIS BRITTANY CLUB (FRIDAY, SATURDAY & MONDAY)

WIREHAired VIZSLA CLUB OF AMERICA (SUNDAY)

ILLINI GREAT DANE CLUB (FRIDAY, SATURDAY, SUNDAY & MONDAY)

PRAIRIELAND STANDARD SCHNAUZER CLUB OF CENTRAL ILLINOIS (FRIDAY & MONDAY)

HEARTLAND STANDARD SCHNAUZER CLUB OF GREATER TWIN CITIES (SATURDAY)

FORT DEARBORN BULL TERRIER CLUB (FRIDAY & SUNDAY)

MINIATURE BULL TERRIER CLUB OF AMERICA (FRIDAY, SUNDAY & MONDAY)

NORTH CENTRAL ILLINOIS PEKINGESE CLUB (FRIDAY & MONDAY)

AKC NATIONAL OWNER-HANDLED SERIES ALL FOUR DAYS

4-6 MO BEGINNER PUPPY COMPETITION SATURDAY & SUNDAY

PLEASE NOTE: All Terrier, Toy, and Non-Sporting Breeds (except Bulldogs) will be judged in the Mini Expo Building & all other breeds will be judged in the West Expo Building.

Interstate Center

1106 Interstate Dr. Bloomington, Illinois 61705

All entries paid by credit card/debit card will be returned if charge is denied for any reason & is not rectified by Thursday, May 7, 2026 by 10:00 am CST
\$25.00 Fee for returned checks for any reason

ENTRY FEES • Separate fee for each dog, each day, each show
(including AKC fees)

When a dog is entered in more than one class, the highest priced class is considered the first entry.

ILLINOIS VALLEY KENNEL CLUB OF PEORIA, INC. & CORN BELT KENNEL CLUB, INC.

First entry of each dog	\$35.00
Additional entry of same dog, unless otherwise specified	\$30.00
Puppy & Bred-By-Exhibitor Classes	\$30.00
Junior Showmanship Competition	FREE
Sweepstakes & Veteran Sweepstakes (where offered)	\$22.00
Brace as a Unit (both dogs must be entered in another class) Sat & Sun	\$30.00
Standard Schnauzer & Pekingese Designated Specialties	
4-6 Mo Beginner Puppy Competition Sat & Sun	\$22.00

CHICAGO BULLDOG CLUB, INC.

First entry of each dog	\$34.00
Additional entry of same dog, unless otherwise specified	\$29.00
Puppy & Bred-By-Exhibitor Classes	\$29.00
Veteran Classes	\$19.00

NOTICE: PLEASE PUT BREED & NAME OF SHOW ON CHECK

Member: Dog Show Superintendents Association



American
Kennel Club
Annually Licensed
Superintendents

John Goosen • Candy E James • Christopher L James
H T (Terry) James • Mary Beth James • Tim E James • Zach James
John McDonald • Sandi McDonald • Antony M Onofrio
Jack David Onofrio • Patricia Onofrio • Sue Onofrio
Tiffany R Fields Peterson • Glen Power • Luann Ramsey • Paula Vester

PO Box 25764 • Oklahoma City, Oklahoma 73125-0764
Phone: (405) 427-8181 • www.onofrio.com

• RIBBON/ROSETTE PRIZES WILL BE AS FOLLOWS •

REGULAR CLASSES		VARIETY GROUPS	
First Prize	Blue	First Prize	Blue
Second Prize	Red	Second Prize	Red
Third Prize	Yellow	Third Prize	Yellow
Fourth Prize	White	Fourth Prize	White
Winners	Purple	Best in Show	Red, White & Blue
Reserve Winners	Purple & White	Reserve Best in Show	Red, Silver & Blue
Best of Winners	Blue & White		
Best of Breed	Purple & Gold		
Best of Variety of Breed	Purple & Gold		
Best of Opposite Sex to Best of Breed			
and to Best of Variety of Breed	Red & White		
Select	Light Blue & White		

NON-REGULAR CLASSES

First Prize	Rose
Second Prize	Brown
Third Prize	Light Green
Fourth Prize	Gray

• CLASSIFICATION •

Regular Classes

Puppy, Dogs	Puppy, Bitches
6 months & under 9 months	6 months & under 9 months
9 months & under 12 months	9 months & under 12 months
Twelve to Eighteen Month, Dogs	Twelve to Eighteen Month, Bitches
*Novice, Dogs	*Novice, Bitches
*Amateur-Owner-Handler, Dogs	*Amateur-Owner-Handler, Bitches
Bred-by-Exhibitor Puppy, Dogs	Bred-by-Exhibitor Puppy, Bitches
Bred-by-Exhibitor Adult, Dogs	Bred-by-Exhibitor Adult, Bitches
American-bred, Dogs	American-bred, Bitches
Open, Dogs	Open, Bitches
WINNERS, DOG	WINNERS, BITCH
Best of Breed (Variety) Competition	

**Novice & Amateur-Owner-Handled classes not offered at the Bulldog Concurrent Specialties.*

The above classification is provided for all breeds (and varieties). Additional divisions, i.e. (age, color or weight) are in the breed list and must be indicated on the entry.

OPEN CLASS DIVISIONS

RETRIEVERS (LABRADOR): Black; Chocolate; Yellow

DACHSHUNDS (ALL THREE VARIETIES): Miniature 11 lbs & under & 12 mos of age or older; Any eligible Dachshund

BOXERS: Brindle; Fawn

DOBERMAN PINSCHERS: Black; AOAC

GIANT SCHNAUZERS: Black; Pepper & Salt

GREAT DANES: Black; Blue; Brindle; Fawn; Harlequin; Mantle; Merle

NEWFOUNDLANDS: Black; Other than Black

CHINESE CRESTEDS: Hairless; Powderpuff

JAPANESE CHIN: Black & White; Black & White with Tan Points; Red & White

BOSTON TERRIERS: Under 15 lbs; 15 lbs & over

CHINESE SHAR-PEI: Brushcoat; Horsecat

AUSTRALIAN SHEPHERDS: Blue Merle; Black; Red Merle; Red

COLLIES (ROUGH): Blue Merle; Sable & White; Tri-Color; White

SHETLAND SHEEPDOGS: Sable & White; AOAC

FOR BRITTANYS & STANDARD SCHNAUZERS DESIGNATED SPECIALTIES ON SUNDAY & BULLDOGS CONCURRENT SPECIALTIES

NON-REGULAR (ADDITIONAL) CLASSES Involving Single Dog Entries

***VETERAN DOG CLASS** - A Class for Dogs seven (7) years or older.

***VETERAN BITCH CLASS** - A Class for Bitches seven (7) years or older.

***NEUTERED DOGS & SPAYED BITCHES ARE ELIGIBLE TO COMPETE IN VETERAN CLASSES AT THE BULLDOG CONCURRENT SPECIALTIES**

FOR BRITTANY DESIGNATED ON SUNDAY

NON-REGULAR (ADDITIONAL) CLASSES Involving Single Dog Entries

FIELD TRIAL DOG CLASS - A Class for Dogs that have placed first, second, third or fourth in an AKC licensed or member field trial.

FIELD TRIAL BITCH CLASS - A Class for Bitches that have placed first, second, third or fourth in an AKC licensed or member field trial.

**FOR STANDARD SCHNAUZERS ON SUNDAY & PEKINGESE ON SATURDAY & SUNDAY
NON-REGULAR (ADDITIONAL) CLASSES Involving Multiple Dog Entries**

As the judge's decision in the Non-Regular Classes involving Multiple Dog Entries is based on the merits of more than one dog or bitch, no one of the dogs or bitches making up the entry judged first in these classes will be eligible to compete for Best of Breed by virtue of having won these classes.

STUD DOG CLASS - For Stud Dogs and two of their Get. It is not necessary that the Get be under the same ownership as that of the Stud Dog. The Stud Dog may be entered separately in one of the regular classes, or if a Champion of Record in Best of Breed Competition, but **MUST** be entered in the Stud Dog Class, the Get **MUST** be entered in one of the regular classes. The Stud Dog shall be considered as one entry and requires one entry fee, this being the regular fee plus the additional class fee if the Stud Dog is entered in another class. The Stud Dog must be shown in the ring with the Get. The class will be judged on the merits of the Get.

BROOD BITCH CLASS - Same as for the Stud Dog except substitute Brood Bitch for Stud Dog and Produce for Get.

BRACE CLASS - Two dogs of the same Breed or Variety of Breed with one or more common owner and both dogs must be entered in another class.

AKC NATIONAL OWNER-HANDLED SERIES FRIDAY, SATURDAY, SUNDAY & MONDAY

The AKC National Owner-Handled Series is a non-titling competition for dogs that are exhibited by their owners that are not professional handlers.

 **“DON'T FORGET TO CHECK THE
OWNER-HANDLED BOX ON THE
ENTRY FORM IF ENTERING THIS**



All dogs that are owner-handled and are not exhibited in the National Owner-Handled Series by professional handlers* meet the requirements for this competition. Exhibitors must declare their dog is Owner-Handled eligible at the time of entry using the check box on the entry form. Eligible dogs will be identified by an asterisk in the steward's book & the catalog. **Dogs must be handled throughout the breed level competition for the regular show by an eligible owner. Professional handlers, household members and current assistants to professional handlers may not exhibit the dog in any AKC National Owner-Handled Series competition during the entire show. A current assistant is defined by anyone employed by a professional handler on a full-time basis, or assisting a professional handler at the show or any show during the cluster/weekend, however current assistants that are eligible to compete in Junior Showmanship (meet age and amateur status requirements) may participate in NOHS.**

Owner-Handled Best of Breed will be selected from the dogs that are competing in the Best of Breed competition including Winners Dog, Winners Bitch and winners of the non-regular classes.

The breed will not be represented in the Owner-Handled Group if there is no eligible dog competing in the Best of Breed, or in Best of Winners competition.

**Professional handlers are defined as any person who belongs or has belonged to a professional handlers' organization, distributed rate cards, or otherwise advertised or represented themselves as handling dogs for pay within the last five years.*

Beginner Puppies (4-6 months of age)
AKC Sanctioned Beginner Puppy Competition!

SATURDAY & SUNDAY

Saturday Judge: Ms Emily Fish

Sunday Judge: Ms Dianne Kroll

Section 1 - Classifications

- The Four-to-Six Month Puppy competition shall be for puppies that are over four months of age but under six months on the day of the event.
- Classes are offered for breeds and varieties and divided into Groups as described in Chapter 3, Section 1 of the Rules Applying to Dog Shows and the Miscellaneous Class breeds as listed in Chapter 3 Section 23. The Miscellaneous class competition will be the equivalent of Group competition and the winner will be eligible to compete in Best Four-to-Six Month Puppy in Show
- The FSS competition will be the equivalent of Group competition and the winner will be eligible to compete in Best Four-to-Six Month Puppy in Show

Section 2 - Entry and Eligibility

Entry and eligibility requirements include:

- Puppies must have one of the following:
 - An Individual registration number registered with the American Kennel Club (AKC)
 - A Foundation Stock Service (FSS) registration number
 - A foreign born dog may enter if they are registered in the country of origin, as defined in Chapter 11, Section 1 of the Rules Applying to Dog Shows
- All entrants are to be vaccinated (including rabies) in accordance with their veterinarian's protocol.
- Professional handlers, members of their household and current assistants to professional handlers may personally exhibit in the Four-to-Six Month (Beginner Puppy) Competition. Entries must be marked "Exhibition Only" prior to the close of entries.
- Dogs that are owned or co-owned by the forenamed may compete for awards in this competition but must be handled by a non-professional handler. Professional handlers are defined as any person who belongs or has belonged to a professional handlers' organization, distributed rate cards, or otherwise advertised or represented themselves as handling dogs for pay within the last five years.
- Minors (under 18) with amateur status who reside with professional handlers and current assistants to professional handlers that are eligible to compete in Junior Showmanship (meet age and amateur status requirements) may personally exhibit dogs in the Four-to-Six Month Beginner Puppy Competition.

Entries will close Wednesday Noon, May 6, 2026 at Superintendent's office.

JUNIOR SHOWMANSHIP COMPETITION

NOVICE JUNIOR CLASS - For Boys and Girls at least 9 and under 12 years of age on the day of the show who at the time entries close, have not won three (3) first place awards★, with competition present, in a Novice Class at a licensed or member show.

NOVICE INTERMEDIATE CLASS - For Boys and Girls at least 12 and under 15 years of age on the day of the show who at the time entries close, have not won three (3) first place awards★, with competition present, in a Novice Class at a licensed or member show.

NOVICE SENIOR CLASS - For Boys and Girls at least 15 and under 18 years of age on the day of the show who at the time entries close, have not won three (3) first place awards★, with competition present, in a Novice Class at a licensed or member show.

OPEN JUNIOR CLASS - For Boys and Girls at least 9 and under 12 years of age on the day of the show who at the time entries close, have won three (3) first place awards★ in a Novice Class at a licensed or member show, with competition present in the Novice Class.

OPEN INTERMEDIATE CLASS - For Boys and Girls at least 12 and under 15 years of age on the day of the show who at the time entries close, have won three (3) first place awards★ in a Novice Class at a licensed or member show, with competition present in the Novice Class.

OPEN SENIOR CLASS - For Boys and Girls at least 15 and under 18 years of age on the day of the show who at the time entries close, have won three (3) first place awards★ in a Novice Class at a licensed or member show, with competition present in the Novice Class.

MASTER CLASS - For Boys and Girls at least 9 and under 18 years of age on the day of the show and who have won ten (10) Best Junior Handler awards with competition. The calendar for this class will be consistent with the eligibility dates for the AKC National Championship. All juniors meeting the criteria for this class are required to enter the Master Class and must change their entry the day of the show if entries have already closed. Once the eligibility time frame for that year has passed, all participants return to the Open Class to compete for the following year.

★ A first place in Novice without competition leading to a Best Junior award with competition counts as one win towards moving to Open.

NOTICE: Junior Handlers must include their AKC JUNIOR HANDLER NUMBER on each entry. To obtain junior identification number contact juniors@akc.org

BE SURE ALL INFORMATION for Junior Showmanship Classes is entered on front and back of entry form

JUDGES

Julia Austin - Oreana IL

Dr Albert P Bianchi - Virginia Beach VA

Ms Sandy Bingham-Porter* - Charleston IL

Ms Juliann Bitter* - Highlandville MO

Mrs Jane Boatman Blackerby* - Merriam KS

Mrs Barbara L Burns* - Freeport IL

Meredith Cairns-Mellen - Columbia TN

Ms Emily Fish* - Camas WA

Stir Greer - Shepherdstown WV

Rebecca Haberbush - Mendota IL

Mrs Stephanie Hamblin-Barnhill* - Lawrence KS

Dr M Patricia Joyce* - Tucker GA

Ms Dianne Kroll* - Aloha OR

Mrs Debbie L Melgreen - Yates City IL

Paul O'Driscoll - Golden Valley MN

Cleo Parker - Livonia MI

Ms Paula Pressler-Tash - Prospect TN

Mrs Ann Radford - Lindsay ON Canada

Dr Judi M Roller* - Mazomanie WI

Ms Ann H Roth* - Wilmington NC

Rhonda Silveira* - Scio OR

Elise Singer - Arthur IL

Mr Robin L Stansell - Clayton NC

Mrs Cindy Stansell - Clayton NC

Mrs Carolyn Taylor - Champaign IL

Mr Merle Taylor - Champaign IL

Mrs Melanie S Whitehair - Holley NY

Mrs Ann F Yuhasz - Aurora OH

* One or more breed assigned approved as provisional/permit by AKC

VARIETY GROUP JUDGES

ILLINOIS VALLEY KC OF PEORIA, INC. (1)-FRIDAY

- Ms Ann H Roth • Sporting Group
- Dr Judi M Roller* • Hound Group
- Mrs Stephanie Hamblin-Barnhill* • Working Group
- Mr Merle Taylor • Terrier Group
- Ms Juliann Bitter* • Toy Group
- Mrs Jane Boatman Blackerby* • Non-Sporting Group
- Mrs Cindy Stansell • Herding Group
- Mr Robin L Stansell • Best In Show

OWNER-HANDLED GROUPS-FRIDAY

- Mrs Jane Boatman Blackerby • Sporting Group
- Mrs Stephanie Hamblin-Barnhill • Hound Group
- Mr Robin L Stansell • Working Group
- Dr Judi M Roller • Terrier Group
- Mrs Jane Boatman Blackerby • Toy Group
- Ms Juliann Bitter • Non-Sporting Group
- Mrs Stephanie Hamblin-Barnhill • Herding Group
- Ms Ann H Roth • Best In Show

CORN BELT KENNEL CLUB, INC. (1)-SATURDAY

- Ms Dianne Kroll • Sporting Group
- Ms Ann H Roth • Hound Group
- Ms Ann H Roth* • Working Group
- Ms Ann H Roth • Terrier Group
- Ms Sandy Bingham-Porter • Toy Group
- Mr Robin L Stansell • Non-Sporting Group
- Ms Emily Fish • Herding Group
- Mrs Cindy Stansell • Best In Show

OWNER-HANDLED GROUPS-SATURDAY

- Mr Robin L Stansell • Sporting Group
- Ms Sandy Bingham-Porter • Hound Group
- Mrs Cindy Stansell • Working Group
- Ms Sandy Bingham-Porter • Terrier Group
- Ms Emily Fish • Toy Group
- Ms Sandy Bingham-Porter • Non-Sporting Group
- Ms Dianne Kroll • Herding Group
- Ms Dianne Kroll • Best In Show

ILLINOIS VALLEY KC OF PEORIA, INC. (2)-SUNDAY

- Ms Emily Fish* • Sporting Group
- Ms Dianne Kroll • Hound Group
- Mr Robin L Stansell • Working Group
- Mrs Ann F Yuhasz • Terrier Group
- Mr Robin L Stansell • Toy Group
- Mrs Cindy Stansell • Non-Sporting Group
- Mrs Ann F Yuhasz • Herding Group
- Dr Albert P Bianchi • Best In Show

OWNER-HANDLED GROUPS-SUNDAY

- Ms Dianne Kroll • Sporting Group
- Mrs Cindy Stansell • Hound Group
- Dr Albert P Bianchi • Working Group
- Mr Robin L Stansell • Terrier Group
- Ms Dianne Kroll • Toy Group
- Dr Albert P Bianchi • Non-Sporting Group
- Mrs Cindy Stansell • Herding Group
- Ms Emily Fish • Best In Show

CORN BELT KENNEL CLUB, INC. (2)-MONDAY

- Mrs Barbara L Burns • Sporting Group
- Rhonda Silveira* • Hound Group
- Dr Albert P Bianchi • Working Group
- Dr M Patricia Joyce* • Terrier Group
- Mrs Carolyn Taylor • Toy Group
- Mrs Carolyn Taylor • Non-Sporting Group
- Dr Albert P Bianchi • Herding Group
- Mrs Ann F Yuhasz • Best In Show

OWNER-HANDLED GROUPS-MONDAY

- Mrs Ann F Yuhasz • Sporting Group
- Mrs Barbara L Burns • Hound Group
- Rhonda Silveira • Working Group
- Rhonda Silveira • Terrier Group
- Dr M Patricia Joyce • Toy Group
- Dr M Patricia Joyce • Non-Sporting Group
- Mrs Barbara L Burns • Herding Group
- Rhonda Silveira • Best In Show

JUDGING ASSIGNMENTS

SPORTING BREEDS	ILVA1-(Fri)	CORB1-(Sat)	ILVA2-(Sun)	CORB2-(Mon)
Barbet	A H Roth	D Kroll	E Fish	A F Yuhasz
Bracchi Italiani	A H Roth	D Kroll	E Fish*	A F Yuhasz
Brittany				
Sweepstakes			R Haberbush	
Veteran Sweepstakes			R Haberbush	
Brittany	A H Roth	D Kroll	E Fish	A F Yuhasz
			Specialty Show	
			Veteran Dog	
			Veteran Bitch	
			Field Trial Dog	
			Field Trial Bitch	
Lagotto Romagnolo	A H Roth	D Kroll	E Fish	A F Yuhasz
Nederlandse Kooikerhondjes	A H Roth	D Kroll	E Fish	A F Yuhasz
Pointers	A H Roth	D Kroll	E Fish*	A F Yuhasz
Pointers (German Shorthaired)	A H Roth	D Kroll	E Fish	A F Yuhasz
Pointers (German Wirehaired)	A H Roth	D Kroll	E Fish	A F Yuhasz
Retrievers (Chesapeake Bay)	A H Roth	D Kroll	E Fish	A F Yuhasz
Retrievers (Curly-Coated)	A H Roth	D Kroll	E Fish	A F Yuhasz
Retrievers (Flat-Coated)	A H Roth	D Kroll	E Fish	A F Yuhasz
Retrievers (Golden)	A H Roth	D Kroll	E Fish	A F Yuhasz
Retrievers (Labrador)	A H Roth	D Kroll	E Fish	A F Yuhasz
Retrievers (Nova Scotia Duck Tolling)				
Setters (English)	A H Roth	D Kroll	E Fish	A F Yuhasz
Setters (Gordon)	A H Roth	D Kroll	E Fish	A F Yuhasz
Setters (Irish)	A H Roth	D Kroll	E Fish*	A F Yuhasz
Setters (Irish Red And White)	A H Roth	D Kroll	E Fish	A F Yuhasz
Spaniels (American Water)	A H Roth	D Kroll	E Fish	A F Yuhasz
Spaniels (Boykin)	A H Roth	D Kroll	E Fish*	A F Yuhasz
Spaniels (Cumber)	A H Roth	D Kroll	E Fish	A F Yuhasz
Spaniels (Cocker) Black	A H Roth	D Kroll	E Fish	A F Yuhasz
Spaniels (Cocker) Ascob	A H Roth	D Kroll	E Fish	A F Yuhasz
Spaniels (Cocker) Parti-Color	A H Roth	D Kroll	E Fish	A F Yuhasz
Spaniels (English Cocker)	A H Roth	D Kroll	E Fish	A F Yuhasz
Spaniels (English Springer)	A H Roth	D Kroll	E Fish	A F Yuhasz
Spaniels (Field)	A H Roth	D Kroll	E Fish*	A F Yuhasz
Spaniels (Irish Water)	A H Roth	D Kroll	E Fish*	A F Yuhasz
Spaniels (Sussex)	A H Roth	D Kroll	E Fish	A F Yuhasz
Spaniels (Welsh Springer)	A H Roth	D Kroll	E Fish	A F Yuhasz
Spinoni Italiani	A H Roth	D Kroll	E Fish	A F Yuhasz
Vizslas	A H Roth	D Kroll	E Fish	A F Yuhasz
Weimaraners	A H Roth	D Kroll	E Fish	A F Yuhasz
Wirehaired Pointing Griffons	A H Roth	D Kroll	E Fish*	A F Yuhasz
Wirehaired Vizslas				
Sweepstakes			R Haberbush	
Veteran Sweepstakes			R Haberbush	
Wirehaired Vizslas	A H Roth	D Kroll	E Fish	A F Yuhasz
HOUD BREEDS	ILVA1-(Fri)	CORB1-(Sat)	ILVA2-(Sun)	CORB2-(Mon)
Afghan Hounds	J M Roller*	A H Roth	D Kroll	R Silveira
American English Coonhounds	J M Roller*	A H Roth	D Kroll	R Silveira

American Foxhounds	J M Roller*	A H Roth	D Kroll	R Silveira*
Azawakhs	J M Roller*	S Bingham-Porter*	D Kroll	R Silveira*
Basenjis	J M Roller	A H Roth	D Kroll	R Silveira
Basset Fauve de Bretagnes	J M Roller*	A H Roth	D Kroll	R Silveira*
Basset Hounds	J M Roller	A H Roth	D Kroll	R Silveira
Beagles (13 Inch)	J M Roller*	S Bingham-Porter*	D Kroll	R Silveira
Beagles (15 Inch)	J M Roller*	S Bingham-Porter*	D Kroll	R Silveira
Black & Tan Coonhounds	J M Roller	A H Roth	D Kroll	B L Burns*
Bloodhounds	J M Roller	A H Roth	D Kroll	R Silveira
Bluetick Coonhounds	J M Roller*	A H Roth	D Kroll	R Silveira
Borzoi	J M Roller	A H Roth	D Kroll	R Silveira*
Cirnechi dell'Etna	J M Roller*	A H Roth	D Kroll	R Silveira*
Dachshunds (Longhaired)	J M Roller	S Bingham-Porter*	D Kroll	R Silveira
Dachshunds (Smooth)	J M Roller	S Bingham-Porter*	D Kroll	R Silveira
Dachshunds (Wirehaired)	J M Roller	S Bingham-Porter*	D Kroll	R Silveira
English Foxhounds	J M Roller*	A H Roth	D Kroll	R Silveira*
Grand Basset Griffon Vendeens	J M Roller	S Bingham-Porter*	D Kroll	R Silveira*
Greyhounds	J M Roller	A H Roth	D Kroll	R Silveira
Harriers	J M Roller*	A H Roth	D Kroll	R Silveira
Ibizan Hounds	J M Roller	A H Roth	D Kroll	R Silveira
Irish Wolfhounds	J M Roller	A H Roth	D Kroll	R Silveira
Norwegian Elkhounds	J M Roller	A H Roth	D Kroll	R Silveira
Otterhounds	J M Roller	A H Roth	D Kroll	R Silveira
Petits Bassets Griffons Vendeens	J M Roller	A H Roth	D Kroll	R Silveira
Pharaoh Hounds	J M Roller	A H Roth	D Kroll	R Silveira
Plott Hounds	J M Roller	A H Roth	D Kroll	R Silveira*
Portuguese Podengo Pequenos	J M Roller*	A H Roth	D Kroll	R Silveira
Redbone Coonhounds	J M Roller	A H Roth	D Kroll	R Silveira*
Rhodesian Ridgebacks	J M Roller	S Bingham-Porter*	D Kroll	R Silveira
Salukis	J M Roller*	A H Roth	D Kroll	R Silveira*
Scottish Deerhounds	J M Roller*	A H Roth	D Kroll	R Silveira*
Sloughis	J M Roller	A H Roth	D Kroll	R Silveira*
Treeing Walker Coonhounds	J M Roller	A H Roth	D Kroll	R Silveira
Whippets	J M Roller	A H Roth	D Kroll	R Silveira
WORKING BREEDS	ILVA1-(Fr)	CORB1-(Sat)	ILVA2-(Sun)	CORB2-(Mon)
Akitas	S Hamblin-Barnhill*	R L Stansell	C Stansell	A P Bianchi
Alaskan Malamutes	S Hamblin-Barnhill*	R L Stansell	C Stansell	A P Bianchi
Anatolian Shepherd Dogs	S Hamblin-Barnhill	R L Stansell	C Stansell	A P Bianchi
Bernese Mountain Dogs	S Hamblin-Barnhill	R L Stansell	C Stansell	A P Bianchi
Black Russian Terriers	S Hamblin-Barnhill	R L Stansell	C Stansell	A P Bianchi
Boerboels	S Hamblin-Barnhill	R L Stansell	C Stansell	A P Bianchi
Boxers	S Hamblin-Barnhill	R L Stansell	C Stansell	A P Bianchi
Bullmastiffs	S Hamblin-Barnhill	A H Roth*	C Stansell	A P Bianchi
Cane Corso	S Hamblin-Barnhill*	R L Stansell	C Stansell	A P Bianchi
Chinooks	S Hamblin-Barnhill*	A H Roth*	C Stansell	A P Bianchi
Danish-Swedish Farmdogs	S Hamblin-Barnhill*	A H Roth*	C Stansell	A P Bianchi
Doberman Pinschers	S Hamblin-Barnhill	R L Stansell	C Stansell	B L Burns
Dogo Argentinos	S Hamblin-Barnhill	A H Roth*	C Stansell	A P Bianchi
Dogues de Bordeaux	S Hamblin-Barnhill	R L Stansell	C Stansell	A P Bianchi
German Pinschers	S Hamblin-Barnhill	A H Roth*	C Stansell	A P Bianchi
Giant Schnauzers	S Hamblin-Barnhill	R L Stansell	C Stansell	A P Bianchi
Great Danes	S Hamblin-Barnhill	R L Stansell	C Stansell	A P Bianchi
Great Pyrenees	S Hamblin-Barnhill	R L Stansell	C Stansell	B L Burns
Greater Swiss Mountain Dogs	S Hamblin-Barnhill	R L Stansell	C Stansell	A P Bianchi
Komondorok	S Hamblin-Barnhill	R L Stansell	C Stansell	B L Burns
Kuvaszok	S Hamblin-Barnhill	R L Stansell	C Stansell	A P Bianchi
Leonbergers	S Hamblin-Barnhill*	R L Stansell	C Stansell	B L Burns
Mastiffs	S Hamblin-Barnhill*	A H Roth*	C Stansell	A P Bianchi
Neapolitan Mastiffs	S Hamblin-Barnhill	A H Roth*	C Stansell	B L Burns
Newfoundlands	S Hamblin-Barnhill	R L Stansell	C Stansell	A P Bianchi
Portuguese Water Dogs	S Hamblin-Barnhill*	A H Roth*	C Stansell	A P Bianchi
Rottweilers	S Hamblin-Barnhill	A H Roth*	C Stansell	A P Bianchi
Saint Bernards	S Hamblin-Barnhill	A H Roth*	C Stansell	A P Bianchi
Samoyeds	S Hamblin-Barnhill	A H Roth*	C Stansell	A P Bianchi
Siberian Huskies	A H Roth	R L Stansell	E Fish	A P Bianchi
Standard Schnauzers				
Sweepstakes			E Singer	
Veteran Sweepstakes			E Singer	
Standard Schnauzers	S Hamblin-Barnhill	R L Stansell	C Stansell	A P Bianchi
			Specialty Show	
			Veteran Dog	
			Veteran Bitch	
			Stud Dog	
			Brood Bitch	
			Brace	
Tibetan Mastiffs	S Hamblin-Barnhill	R L Stansell	C Stansell	A P Bianchi
TERRIER BREEDS	ILVA1-(Fr)	CORB1-(Sat)	ILVA2-(Sun)	CORB2-(Mon)
Airedale Terriers	M Iaylor	A H Roth	A F Yuhasz	M P Joyce

American Hairless Terriers	M Taylor	A H Roth	A F Yuhasz	M P Joyce
American Staffordshire Terriers	M Taylor	A H Roth	A F Yuhasz	M P Joyce
Australian Terriers	M Taylor	A H Roth	A F Yuhasz	M P Joyce
Bedlington Terriers	M Taylor	A H Roth	A F Yuhasz	M P Joyce
Border Terriers	M Taylor	A H Roth	A F Yuhasz	M P Joyce
Bull Terriers (Colored)				
Sweepstakes		P O'Driscoll	D L Melgreen	
Bull Terriers (Colored)	M S Whitehair	A Radford	C Parker	P Pressler-Tash
		Specialty Show		
Bull Terriers (White)				
Sweepstakes		P O'Driscoll	D L Melgreen	
Bull Terriers (White)	M S Whitehair	A Radford	C Parker	P Pressler-Tash
		Specialty Show		
Cairn Terriers	M Taylor	A H Roth	A F Yuhasz	M P Joyce
Cesky Terriers	M Taylor	A H Roth	A F Yuhasz	M P Joyce
Dandie Dinmont Terriers	M Taylor	A H Roth	A F Yuhasz	M P Joyce
Fox Terriers (Smooth)	M Taylor	A H Roth	A F Yuhasz	M P Joyce*
Fox Terriers (Wire)	M Taylor	A H Roth	A F Yuhasz	M P Joyce
Glen of Imaal Terriers	M Taylor	A H Roth	A F Yuhasz	M P Joyce
Irish Terriers	M Taylor	A H Roth	A F Yuhasz	M P Joyce
Kerry Blue Terriers	M Taylor	A H Roth	A F Yuhasz	M P Joyce
Lakeland Terriers	M Taylor	A H Roth	A F Yuhasz	M P Joyce
Manchester Terriers (Standard)	M Taylor	S Bingham-Porter	A P Bianchi	M P Joyce*
Miniature Bull Terriers				
Sweepstakes		P O'Driscoll		
Veteran Sweepstakes		P O'Driscoll		
Miniature Bull Terriers	M S Whitehair	A Radford	C Parker	P Pressler-Tash
		Specialty Show		
Miniature Schnauzers	M Taylor	A H Roth	A F Yuhasz	M P Joyce*
Norfolk Terriers	M Taylor	A H Roth	A F Yuhasz	M P Joyce
Norwich Terriers	M Taylor	A H Roth	A F Yuhasz	M P Joyce*
Parson Russell Terriers	M Taylor	A H Roth	A F Yuhasz	M P Joyce
Rat Terriers	M Taylor	A H Roth	A F Yuhasz	M P Joyce
Russell Terriers	M Taylor	A H Roth	A F Yuhasz	M P Joyce
Scottish Terriers	M Taylor	A H Roth	A F Yuhasz	M P Joyce
Sealyham Terriers	M Taylor	A H Roth	A F Yuhasz	M P Joyce
Skye Terriers	M Taylor	A H Roth	A F Yuhasz	M P Joyce
Soft Coated Wheaten Terriers	M Taylor	A H Roth	A F Yuhasz	M P Joyce
Staffordshire Bull Terriers	M Taylor	A H Roth	A F Yuhasz	M P Joyce
Teddy Roosevelt Terriers	M Taylor	A H Roth	A F Yuhasz	M P Joyce*
Welsh Terriers	M Taylor	A H Roth	A F Yuhasz	M P Joyce
West Highland White Terriers	M Taylor	A H Roth	A F Yuhasz	M P Joyce
TOY BREEDS	ILVA1-(Fr)	CORB1-(Sat)	ILVA2-(Sun)	CORB2-(Mon)
Affenpinschers	R L Stansell	E Fish*	A P Bianchi	C Taylor
Biewer Terriers	J Bitter*	E Fish*	A P Bianchi	C Taylor
Brussels Griffons	R L Stansell	E Fish*	A P Bianchi	C Taylor
Cavalier King Charles Spaniels	R L Stansell	E Fish*	A P Bianchi	C Taylor
Chihuahuas (Long Coat)	R L Stansell	E Fish*	A P Bianchi	C Taylor
Chihuahuas (Smooth Coat)	R L Stansell	E Fish*	A P Bianchi	C Taylor
Chinese Cresteds	J Bitter	S Bingham-Porter	A P Bianchi	C Taylor
English Toy Spaniels (B & P C)	J Bitter	S Bingham-Porter	D Kroll*	C Taylor
English Toy Spaniels (K C & R)	J Bitter	S Bingham-Porter	D Kroll*	C Taylor
Havanese	R L Stansell	E Fish*	A P Bianchi	C Taylor
Italian Greyhounds	R L Stansell	E Fish*	A P Bianchi	C Taylor
Japanese Chin	J Bitter*	S Bingham-Porter	A P Bianchi	C Taylor
Maltese	J Bitter*	S Bingham-Porter	A P Bianchi	C Taylor
Manchester Terriers (Toy)	M Taylor	S Bingham-Porter	A P Bianchi	M P Joyce*
Miniature Pinschers	R L Stansell	E Fish*	A P Bianchi	C Taylor
Papillons	R L Stansell	E Fish*	A P Bianchi	C Taylor
Pekingese				
Sweepstakes		M Cairns-Mellen	S Greer	
Pekingese	J Bitter	S Bingham-Porter	A P Bianchi	B L Burns
		Specialty Show	Specialty Show	
		Stud Dog	Stud Dog	
		Brood Bitch	Brood Bitch	
		Brace	Brace	
Pomeranians	R L Stansell	E Fish*	A P Bianchi	C Taylor
Poodles (Toy)	J B Blackerby*	S Bingham-Porter	A P Bianchi	B L Burns*
Pugs	J B Blackerby	S Bingham-Porter	A P Bianchi	B L Burns
Russian Toys	J Bitter*	E Fish*	A P Bianchi	C Taylor
Russian Tsvetnaya Bolonki	J Bitter*	S Bingham-Porter	A P Bianchi	C Taylor
Shih Tzu	R L Stansell	E Fish*	A P Bianchi	C Taylor
Silky Terriers	J Bitter	S Bingham-Porter	A P Bianchi	C Taylor
Toy Fox Terriers	J Bitter*	S Bingham-Porter	A P Bianchi	C Taylor
Yorkshire Terriers	J Bitter	S Bingham-Porter	A P Bianchi	C Taylor
NON-SPORTING BREEDS	ILVA1-(Fr)	CORB1-(Sat)	ILVA2-(Sun)	CORB2-(Mon)
American Eskimo Dogs	J B Blackerby	C Stansell	R L Stansell	C Taylor
Bichons Frises	J B Blackerby	C Stansell	R L Stansell	C Taylor
Boston Terriers	J B Blackerby	C Stansell	R L Stansell	C Taylor

Bulldogs				
Sweepstakes	J Austin			
Bulldogs	J B Blackerby	C Stansell	R L Stansell	C Taylor
Chinese Shar-Pei	J B Blackerby	C Stansell	R L Stansell	C Taylor
Chow Chows	J B Blackerby	C Stansell	R L Stansell	C Taylor
Coton de Tulear	J B Blackerby	C Stansell	R L Stansell	C Taylor
Dalmatians	J B Blackerby	C Stansell	R L Stansell	C Taylor
Finnish Spitz	J B Blackerby	C Stansell	R L Stansell	C Taylor
French Bulldogs	J B Blackerby	C Stansell	R L Stansell	C Taylor
Keeshonden	J B Blackerby	C Stansell	R L Stansell	C Taylor
Lhasa Apsos	J B Blackerby	S Bingham-Porter	A P Bianchi	C Taylor
Lowchen	J B Blackerby	C Stansell	R L Stansell	C Taylor
Norwegian Lundehunds	J B Blackerby	C Stansell	R L Stansell	C Taylor
Poodles (Miniature)	J B Blackerby*	S Bingham-Porter	A P Bianchi	B L Burns*
Poodles (Standard)	J B Blackerby*	S Bingham-Porter	A P Bianchi	B L Burns*
Schipperkes	J B Blackerby	C Stansell	R L Stansell	C Taylor
Shiba Inu	J B Blackerby	C Stansell	R L Stansell	C Taylor
Tibetan Spaniels	J B Blackerby	C Stansell	R L Stansell	C Taylor
Tibetan Terriers	J B Blackerby	C Stansell	R L Stansell	C Taylor
Xoloitzcuintli	J B Blackerby	C Stansell	R L Stansell	C Taylor

HERDING BREEDS	ILVA1-(Fr)	CORB1-(Sat)	ILVA2-(Sun)	CORB2-(Mon)
Australian Cattle Dogs	C Stansell	E Fish	D Kroll*	A P Bianchi
Australian Shepherds	C Stansell	E Fish	D Kroll*	A P Bianchi
Bearded Collies	C Stansell	E Fish	A F Yuhasz	A P Bianchi
Beaucerons	C Stansell	E Fish	A F Yuhasz	A P Bianchi
Belgian Laekenois	C Stansell	E Fish	A F Yuhasz	A P Bianchi
Belgian Malinois	C Stansell	E Fish	A F Yuhasz	A P Bianchi
Belgian Sheepdogs	C Stansell	E Fish	D Kroll*	A P Bianchi
Belgian Tervuren	C Stansell	E Fish	A F Yuhasz	A P Bianchi
Bergamasco Sheepdogs	C Stansell	E Fish	A F Yuhasz	A P Bianchi
Berger Picards	C Stansell	E Fish	A F Yuhasz	A P Bianchi
Border Collies	C Stansell	E Fish	A F Yuhasz	A P Bianchi
Bouviere des Flandres	C Stansell	E Fish	D Kroll*	A P Bianchi
Briards	C Stansell	E Fish	A F Yuhasz	B L Burns
Canaan Dogs	C Stansell	E Fish	A F Yuhasz	A P Bianchi
Cardigan Welsh Corgis	C Stansell	E Fish	D Kroll*	A P Bianchi
Collies (Rough)	C Stansell	E Fish	A F Yuhasz	A P Bianchi
Collies (Smooth)	C Stansell	E Fish	A F Yuhasz	A P Bianchi
Entlebucher Mountain Dogs	C Stansell	E Fish	D Kroll*	A P Bianchi
Finnish Lapphunds	C Stansell	E Fish	D Kroll*	A P Bianchi
German Shepherd Dogs	C Stansell	E Fish	A F Yuhasz	A P Bianchi
Icelandic Sheepdogs	C Stansell	E Fish	D Kroll*	B L Burns
Lancashire Heelers	C Stansell	E Fish	D Kroll*	A P Bianchi
Miniature American Shepherds	C Stansell	E Fish	D Kroll*	A P Bianchi
Mudik	C Stansell	E Fish	D Kroll*	A P Bianchi
Norwegian Buhunds	C Stansell	E Fish	D Kroll*	A P Bianchi
Old English Sheepdogs	C Stansell	E Fish	A F Yuhasz	A P Bianchi
Pembroke Welsh Corgis	C Stansell	E Fish	D Kroll*	B L Burns
Polish Lowland Sheepdogs	C Stansell	E Fish	A F Yuhasz	A P Bianchi
Pulik	C Stansell	E Fish	D Kroll*	A P Bianchi
Pumik	C Stansell	E Fish	D Kroll*	B L Burns
Pyrenean Shepherds	C Stansell	E Fish	A F Yuhasz	A P Bianchi
Shetland Sheepdogs	C Stansell	E Fish	D Kroll*	A P Bianchi
Spanish Water Dogs	C Stansell	E Fish	D Kroll*	A P Bianchi
Swedish Vallhunds	C Stansell	E Fish	A F Yuhasz	A P Bianchi

MISC CLASS	ILVA1-(Fr)	CORB1-(Sat)	ILVA2-(Sun)	CORB2-(Mon)
-------------------	-------------------	--------------------	--------------------	--------------------

Alaskan Klee Kai, Bolognese, Czechoslovakian Vlcia, Dutch Shepherds, German Spitz, Japanese Akitainu, Kai Kens, Norrbottenspets, Peruvian Inca Orchids, Portuguese Podengo, Pyrenean Mastiffs, Small Munsterlander & Yakutian Laikas.

There will be Puppy, Bred-By-Exhibitor and Open Classes for each of the Miscellaneous Breeds in each sex.

	R L Stansell	E Fish	A F Yuhasz	B L Burns
JUNIOR SHOWMANSHIP	ILVA1-(Fr)	CORB1-(Sat)	ILVA2-(Sun)	CORB2-(Mon)
	R L Stansell	D Kroll	E Fish	A F Yuhasz

HOTELS & MOTELS THAT WILL ACCEPT DOGS

Rates subject to change - please check with hotel at time of booking

Make reservations early – last year some of the hotel blocks filled before the deadline. Blocks will be released on April 29. **You MUST contact the hotel directly and indicate that you are with the Heart of Illinois dog shows to get the discounted room rates.** Some hotels have a 2 dog limit – please check with your location.

PLEASE NOTE: *We have worked very hard with our hotels and motels to maintain the acceptance of dogs at these facilities. As you know, more and more hotels are refusing to accept dogs – or are charging extremely high pet fees due to previous issues with animals at their properties. Please control and clean up after your dogs. Notice that our hotels have reduced or waived the pet fees – PLEASE CONTROL YOUR DOGS IN YOUR ROOMS AND CLEAN UP AFTER YOUR DOGS EVERYWHERE!*

Several of the hotels have recently been renovated. Please bring a sheet, towel or something soft to put under your crates to protect the new flooring you will be billed for any damage.

If your dog has an accident, please notify the front desk ASAP so they can bring the appropriate products to properly clean the spot. Do not use the hotel towels for dog bathing or cleaning up. You will be billed for any damage – and be subject to event committee hearing. Although rates are going up everywhere, the hotels have agreed to keep the same rates as last year - just for our exhibitors. Please be good guests to show your appreciation!

WARNING

Problems will be reported to the show-giving Clubs & AKC. Violators will be subject to Show Committee hearings & possible suspension.

NOTE CUT-OFF DATE - MAY 6, 2026

Country Inn & Suites

923 Maple Hill Rd.
Bloomington, IL 61705

Recently remodeled

Double Queen Rooms – refrigerator & microwave

Complimentary Breakfast

Rate of \$119.00 + tax (Reduced pet fee if booked within the block at these reduced room rates – flat \$50.00 fee)

Book by calling (309) 828-7177 - ask for Heart of Illinois Cluster Dog Show block for special rate

Ramada Limited

919 Maple Hill Rd.
Bloomington, IL 61705

Recently remodeled

Double Queen Rooms

Refrigerator

Complimentary breakfast

Rate of \$109.00 + tax (Reduced pet fee if booked within the block at these reduced room rates – flat \$50.00 fee)

Book by calling (309) 319-6998 - ask for Heart of Illinois Cluster Dog Show block for special rate

BOOTH SPACE

ALL VENDOR SPACES INSIDE (four day weekend) (electric included)

**Rate per 10 Ft X 10 Ft Booth, \$200.00 includes electric
Limited booth space will be available by invitation only**

CONTACT:

**Thomas Mair • 209 Mecherle Dr, Bloomington IL 61701
(765) 430-6369 • thmair@yahoo.com**

Please include "HOIC 2026" in the subject line when emailing reservations.

Space for invited vendors who have not reserved their space by **March 13, 2026** shall be considered vacated, and will be available to new vendors on a first come basis.

SHOW PHOTOGRAPHER

Melia Photography
7613 S 72nd Ave
LaVista NE 68128
(402) 331-5071

Select & purchase Pictures on the website
meliaphotography.com

EMERGENCY SHOW VETERINARIAN

Animal Emergency Clinic
118 Greenwood Ave, Bloomington IL 61704
(309) 665-5020
Mon-Fri 6:00 pm - 8:00 am
Weekend: Saturday Noon - Tuesday 8:00 am

SHOW VETERINARIAN (ON CALL)

Dr Max Huschen
Eastland Animal Hospital
1704 East Empire St, Bloomington IL 61704
(309) 662-7387
During Regular Clinic Hours:
Thur & Fri 7:30 am - 5:30 pm
Saturday 8:00 am - Noon
Closed on Sunday & Monday

EMERGENCY SHOW VETERINARIAN

Tri County Animal Emergency Clinic
1800 N Sterling Ave, Peoria IL 61604
(309) 672-1565
Mon-Fri: 5:30 pm - 8:00 am
Sat-Sun: 24 Hrs

EMERGENCY SHOW VETERINARIAN

Animal Emergency Clinic of Springfield
821 S. Durkin Dr, Springfield IL 62704
(217) 698-0870
Every day: 6:00 pm - 8:00 am
Holidays: 24 Hrs

DIRECTIONS TO ANIMAL EMERGENCY CLINIC: Exit show site taking a left (east) on to Rt 9 (Market St). Keep to the right. Take I-55/I-74 south. Keep to the left. Stay on I-74 east. Take 1st exit 134B (Veterans Pkwy). Go north on Veterans Pkwy to 3rd traffic light. Turn right onto Greenwood Avenue. Clinic is straight ahead.

DIRECTIONS TO EASTLAND ANIMAL HOSPITAL: Exit show site taking a left (east) on to Rt 9 (Market St). Keep to the right. Take I-55/I-74 south. Keep to the left. Stay on I-74 east. Take 1st exit 134B (Veterans Pkwy). Go north on Veterans Pkwy approximately 6.1 miles. Turn right on to IL-Rt 9 move to left lane immediately. At first stop light (Mt Vernon/Prospect) turn left on to Mt Vernon Dr. Take immediate left which is E Empire. 1704 E Empire is on the right.

ROUTES TO THE SHOW

- FROM NORTH:**Take 1-55 south to Rt 9- Exit 160 B,west 1 mile.
- FROM SOUTH:**Take 1-55 OR 1-74 north.Turn west on Rt 9- Exit 160 B,1 mile.
- FROM WEST:**Take I-74.Turn west on Rt 9- Exit 160 B,1 mile.

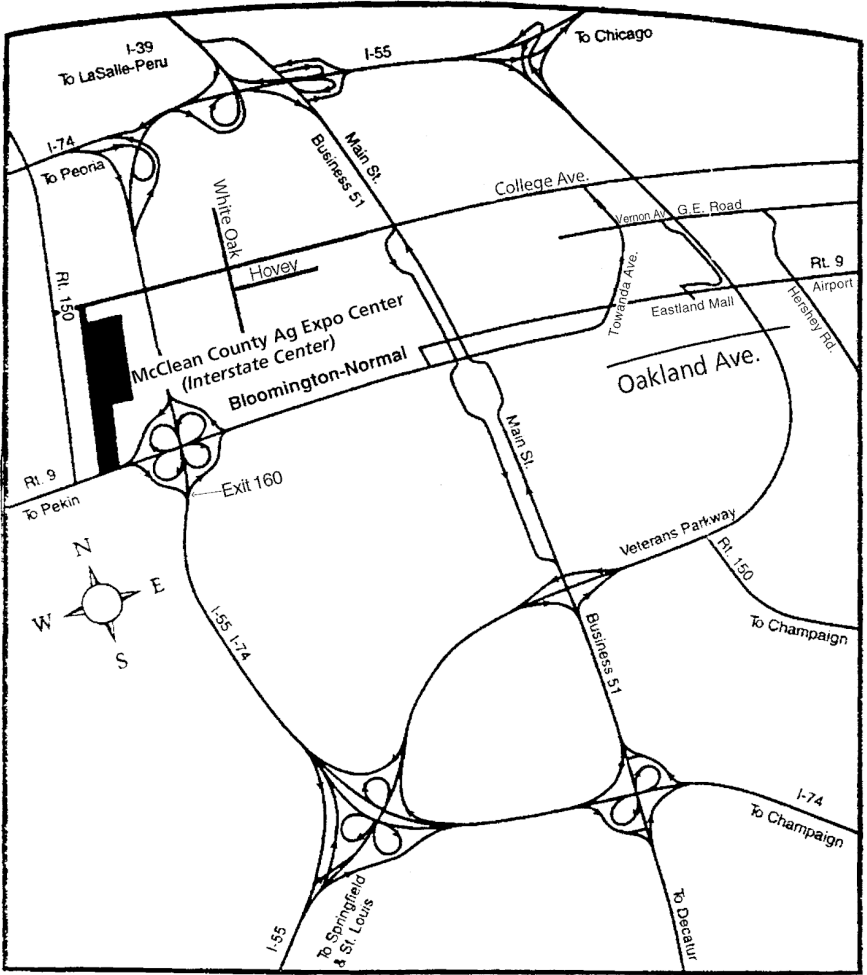

RESERVED OVERNIGHT PARKING REQUIREMENTS

ALL RESERVED PARKING RESERVATIONS ARE ONLINE

RV parking, reserved day parking under cover, reserved day parking west of West Expo

To make a reservation, go to

["Link to instructions for how to book Heart of Illinois Dog Show Parking"](#).

You may also go to www.cornbeltkenelclub.org

If you have questions, email hoiclustershows@gmail.com

Look at the map/excel and select your preferred space

- Email hoiclustershows@gmail.com - Name, address, cell phone number, email address, length of vehicle (for RVs), and license plate number(s), day and time of arrival and space you would like to reserve
- We will accept Venmo or Check by USPS
- You will receive an email confirmation for your reservation. **BRING YOUR CONFIRMATION WITH YOU TO THE SHOWS.** Upon arrival you will receive a parking pass which must be displayed at all times.
- By making your online reservation you agree to abide by all parking rules and regulations, and understand that should you fail to do so, your vehicle may be removed from the showgrounds at your expense, and you will receive no refund of the parking fee paid.
- No refunds after show closing date May 6.
- **DEADLINES**
 - Payments by Check - May 9, 2026
 - Payments by Venmo - May 16, 2026

Make your reservations early - Electric spaces sold out last year - there is plenty of non-electric parking available.

If you arrive prior to Thursday AM, please consider Love's near the show site

Love's Travel Stop, 2007 N Main St, Normal IL 61701

New - Large RV park - dog friendly

NO ADMITTANCE TO RESERVED RV PARKING AREAS PRIOR TO 10:00 AM THURSDAY.

SEE MAP [PAGE 23](#)

PARKING QUESTIONS: hoiclustershows@gmail.com

FOR EMERGENCY BETWEEN 4:30 PM-9:00 PM CDT ONLY

309-838-9281

1. All RV, Overnight Parking, and Day Parking requesting set ups that can be left overnight is by reservation only. Space is Limited. RV spaces are approximately 25'x50'. Car parking is approximately 15'x35'. If you cannot fit within these dimensions you will need to unhook (if towing) or reserve more than one space. Some spots require extra long cords.
2. Reservations are on a first-come, first-served basis.
3. Reservations are for the entire event only.
4. Water filling and dumping on site is available, however RV's may not stay "hooked up".
5. Electrical outlets are limited to 125 volt/**30 AMP** service on the outside "OPEN" grid, and **20 AMP** service under cover.
 - A limited number of "splitter" 30 AMP spaces are available on a first-come, first-served basis and must be requested at time of reservation. This allows you to use two (2) 30 AMP outlets. You must provide your own splitter.

6. **Parking:**

- Day Parking - Cars- Reserved, Building B & C.....\$50/per space/4 days
- Day Parking- Box vans, lg vehicles, no elec.....\$60/ per space/4 days
- RV Regular Outside (No Electric)..... \$80/ per space/4 days
- RV Regular Outside With Electric..... \$160/ per space/4 days
- RV Regular Outside with Splitter Electric..... \$180/ per space/4 days
- Under Cover (Limited: under 34 feet and 20 amp service, 1 outlet):
Building D (concrete floor): \$150/ per space/ 4 days
Building A: \$180/ per space/ 4 days

THOSE ARRIVING WITHOUT RESERVATIONS MUST PAY CASH + \$25.00 FEE

7. Additional Parking available without electric

8. Golf carts are available from: Prairieland Golf Carts

- CLUBS RESERVE THE RIGHT TO DISALLOW FURTHER USE OF GOLF CARTS FOR RECKLESS DRIVING.

PARKING - EXHIBITOR AND SPECTATOR - RULES AND REGULATIONS

- ALL PARKING SHALL BE AT THE EXCLUSIVE & EXPLICIT DIRECTION OF THE HEART OF ILLINOIS CLUSTER COMMITTEE & ITS ASSIGNED COMMITTEE REPRESENTATIVES. VIOLATION WILL RESULT IN TOWING OF VEHICLE.
- DAMAGE TO ELECTRICAL EQUIPMENT PROVIDED FOR RV PARKING WILL BE CHARGED TO THE PERSONS RENTING THAT PARKING SPACE. PLEASE CHECK & MAKE SURE THAT YOU HAVE DISCONNECTED BEFORE LEAVING YOUR SPACE & THAT ELECTRICAL BOXES ARE CLEAR FROM TRAFFIC.
- All Parking is in designated areas only.
- All parking is at the exhibitor's risk. The clubs and management assume no responsibility for fire, theft and/or loss or damage to any rig or its cargo.
- There are no designated handicap RV spaces. Spaces are assigned on a first come first serve basis.

PARKING - RVs & TRAILERS

- **No admittance to Reserved RV parking areas prior to 10:00 am Thursday.**
- For those exhibitors who arrive in Bloomington before the designated RV campground is ready, it is suggested you check with the local campgrounds for availability.
- **The Interstate Center RV Campground is available Thursday, at 10:00 am.**
- No water hook-ups available, however there is water available for filling on-site. Vehicles may not remain "hooked-up".
- No sewer hook-ups but free dumping is available on-site.
- Showers available 24 hours in Building B.
- **NO OPEN FIRE PITS OR CAMPFIRES PERMITTED.**
- **QUIET TIME WILL BE OBSERVED BETWEEN 10:00 PM & 5:00 AM NIGHTLY.**
- Reservations received only from those coming for the entire event will be processed. Payment must be enclosed or reservation form will not be processed.
- Overnight parking is a privilege. This privilege may be withdrawn from any person who does not adhere to the rules & instructions, uses foul language to parking personnel or abuses the parking lot equipment.
- Phone number for RV **EMERGENCY ONLY** (309) 838-9281

Car parking in the RV area is LIMITED TO YOUR SPACE. PARKING IN THE ACCESS DRIVES OR IN FRONT OF ANOTHER PERSON'S SPACE IS STRICTLY PROHIBITED. OVERNIGHT PARKING MAY BE WITHDRAWN FROM ANY PERSONS OR GROUPS OF PEOPLE WHO DO NOT ADHERE TO THIS RULE. Visitors who cannot fit within the confines of your space must park in the free public parking areas.

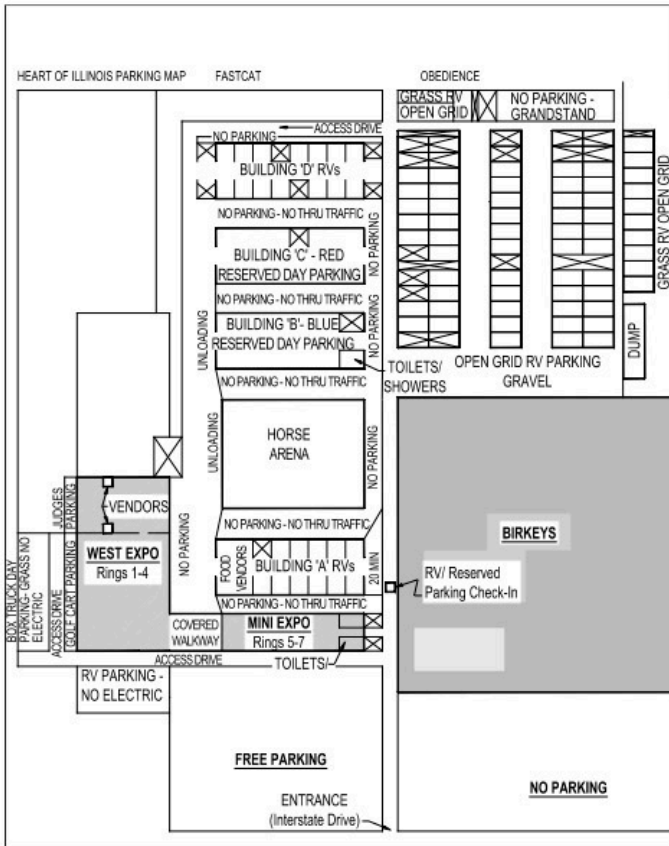

PLEASE NOTE THE FOLLOWING GOLF CART RENTAL INFORMATION:

As a courtesy to the exhibitors, the show giving clubs and cluster are providing the following information with regard to golf cart rental. Golf carts can be rented by making direct arrangements with Prairieland Golf Carts. Exhibitors and those wishing to use this service MUST CALL PRAIRIELAND GOLF CARTS DIRECTLY (309-820-1936) and must indicate that although they are coming to participate in the dog show, they are making arrangements directly between Prairielands and themselves. They must indicate that they are not associated with the cluster, superintendent or the show giving clubs. Please ensure you discuss delivery, pick-up and payment arrangements. This information is provided ONLY as a courtesy for those wishing to utilize golf-cart rental service. The show giving clubs, cluster, superintendent, volunteers and employees are not responsible for any loss or damage and absolve themselves of any responsibility and/or liability to those utilizing golf cart rental service. **MISUSE OF GOLF CARTS MAY RESULT IN AN EVENT COMMITTEE HEARING.**

OPENING DATE - MARCH 25, 2026 @ 6:00 pm CDT
CLOSING DATE - MAY 17, 2026 @ 6:00 pm CDT

CORN BELT KENNEL CLUB
(assisted by Town & Country Kennel Club)
Heart of Illinois Cluster Dog Shows

Saturday & Sunday, May 23 & 24, 2026

Interstate Center
1106 Interstate Dr
Bloomington IL 61705

AKC FASTCAT

SECRETARY:

Erin Seely

PO Box 316, Roscoe IL 61073

(815) 980-5961

Secretary@TallyHoEvents.com

Cost \$27.00

No bitches in season
No lame dogs
(dogs will be checked
for soundness prior to running)

For the FCAT premium list with all the information
and entry form, go to

<https://www.TallyHoEvents.com>

ABOUT OUR SHOW SITE:

The Interstate Center is located on the west side of Bloomington/Normal, just west of I-55 at exit 160. It is close to restaurants & lodging.

All buildings will be available for set up on Thursday at 10:00 am. All dogs & equipment must be removed at the conclusion of the Monday show.

ATTENTION EXHIBITORS

GENERAL:

- The Show Exposition buildings will be available to exhibitors **Thursday at 10:00 am**. On Friday, Saturday, Sunday & Monday, the building will be open at 6:00 am. **All dogs & equipment must be removed immediately after Best in Show judging on Monday.** ALL buildings will be secured at 10:15 pm & lights will be turned off & doors locked at 10:30 pm each night. No one permitted to remain in building after 10:30 pm.
- **SPECIAL NOTE:** The Interstate Center will not allow anyone to sleep overnight in the buildings.
- This is a **NON-SMOKING FACILITY**. Smoking is allowed outside only.
- The welfare of an exhibitor's child is assumed to be the responsibility of the exhibitor. It is distinctly understood that exhibitors will exercise **Control & Restraint** over their children while attending these shows.
- The Show Committees from the participating clubs assume no responsibility for fire, theft and/or loss or damage to any animal, equipment or personal items brought into the Interstate Center or dogs left overnight.

SPECIFIC:

UNLOADING & LOADING

- **No unloading into the buildings will be permitted prior to 10:00 am on Thursday, May 21, 2026.**
- ALL PARKING SHALL BE AT THE EXCLUSIVE & EXPLICIT DIRECTION OF THE HEART OF ILLINOIS CLUSTER PARKING COMMITTEE & ITS ASSIGNED COMMITTEE REPRESENTATIVES. VIOLATION WILL RESULT IN TOWING OF VEHICLE.
- No vehicle will be permitted to drive into the Interstate Center.
- Loading & unloading will be permitted in designated areas only. Please follow directives of the Cluster representatives.
- **All dogs & equipment must be removed immediately after Best in Show judging on Monday.**

CRATING & GROOMING

- **Crating at ringside permitted ONLY during the judging of that specific breed where space permits at the discretion of the show committee.**
- **All grooming & crating is in designated areas only. It will be on a first-come first-serve basis. Roping off or saving unused crating space is strictly prohibited.**
- **All crates must be stacked.**
- **Each exhibitor is responsible for clean conditions in & around his or her set up area. Remember to bring a broom.**
- **Chairs in the grooming area may be limited at the discretion of the Show Committee.**
- **No drop pens or exercise pens will be permitted in any of the buildings.**
- **For dogs left in buildings overnight, emergency contact information must be clearly displayed within the set up.**

EXERCISE PENS & AREAS

- **EXHIBITORS MUST CLEAN UP AFTER THEIR OWN DOGS IN ALL GRASS AND PAVED AREAS OF THE INTERSTATE CENTER GROUNDS. No clean-up personnel on fair grounds.**
- NO PRIVATE EXERCISE PENS ALLOWED IN THE BUILDINGS.
- NO mats or carpets are allowed inside the building. Violators will have their equipment removed from the building.
- Public exercise areas will be provided inside the building or under cover. Please clean up after your dog in the public ex pens. Private exercise areas provided outside.

The Illinois Valley Kennel Club of Peoria, Inc. & the Corn Belt Kennel Club, Inc. do not agree to arbitrate claims as set forth on the Official AKC entry form for these events.

The following breeds may be judged on the ground or on a ramp: Nova Scotia Duck Tolling Retrievers, American Water Spaniels, Boykin Spaniels, Field Spaniels, Welsh Springer Spaniels, Grand Basset Griffon Vendéens, Norwegian Elkhounds, Whippets, German Pinschers, Portuguese Water Dogs, Standard Schnauzers, American Staffordshire Terriers, Irish Terriers, Soft Coated Wheaten Terriers, Staffordshire Bull Terriers, Finnish Spitz, Entlebucher Mountain Dogs, Finnish Lapphunds, Icelandic Sheepdogs, Norwegian Buhunds, Australian Cattle Dogs, Polish Lowland Sheepdogs, Basset Fauve de Bretagne (Misc) and Norrbottenspets (Misc).

The following breed may be judged on the ground, a ramp, or on a table: Miniature Bull Terriers.

The following breeds may be judged on a ramp or on a table: Basenjis, Mudik and Pulik

The following breeds must be judged on a ramp through all levels of conformation competition: Lagotti Romagnoli, Clumber Spaniels, English Springer Spaniels, Sussex Spaniels, Basset Hounds, Cirneco dell'Etna, Kerry Blue Terriers, Bulldogs, Chinese Shar-Pei, Chow Chows, Keeshonden and Spanish Water Dogs.

The AKC is committed to creating a safe and respectful sport environment for all. If you need to talk to someone, or need help, please call 800.656.HOPE (National Sexual Assault Hotline) or text HOME to 741-741 for free, 24/7, confidential services from trained crisis counselors.

PUBLICATION RIGHTS: By entering this show, all owners, handlers, breeders and kennels agree that all rights to televise, videotape, photograph, advertise, promote and publicize or otherwise exploit this show, or the persons or animals participating in it or the results of the competition before, during or after the event, shall belong solely to The American Kennel Club and their respective assigns, including the use of the names, likenesses or biographical matter of all dogs, owners, handlers, breeders and kennels participating in the show and no such owner, handler, breeder or kennel shall allow any other party to make commercial use of any videotape or photograph of any person or animal participating in this competition.

NEW EXHIBITOR BRIEFING on Saturday. Check Judging Program for time & location.

An AKC Recording Fee and Service Fee of \$4.50 for each entry. An AKC Event Service Fee of \$3.00 per entry will be required for each dog entered at any 4 & Under 6 Months Puppy and Open Show. All Recording and Event Service Fees are paid to the American Kennel Club. (There is no Recording Fee or Event Service Fee for Junior Showmanship, Sweepstakes, Futurities, Brace/Team, Multi-Dog Classes or Special Attractions.)

CANADIAN/FOREIGN EXHIBITORS MUST SUBMIT ENTRIES WITH CHECKS DRAWN ON U.S. ACCOUNTS OR WITH INTERNATIONAL MONEY ORDERS IN U.S. FUNDS.

Entries received prior to the published opening date and time of entries or received prior to the publishing of this premium list will be returned without processing.

A service/processing fee of \$7.00 will be charged to each duplicate entry.

Dogs need be present only for scheduled judging and will be released if not needed for further judging.

Dogs allowed in rings during judging only.

Dogs must be ready for judging. Neither the club nor its Superintendents will be responsible or obligated to furnish any service for notifying exhibitors or their agents of Breed or Class Judging. Judges need not wait for any dog holding up a class. **Owners or agents alone are responsible for the presence of their dogs in the judging rings.**

The Club reserves the right to substitute a prize of equal or greater value.

All trophies must be claimed the day of the show - None will be mailed.

All checks issued as prizes are the sole responsibility of the recipient. Lost, stolen and/or misplaced checks will not be replaced. Checks are valid for 90 days. The Superintendent is not able to cash checks nor will they be accepted toward entry fees.

RETURNED CHECKS/DECLINED CREDIT/DEBIT CARDS do not constitute a valid entry fee. Fees must be paid in guaranteed funds. Checks will not be accepted. The Superintendent will add a fee for completing the transaction and/or reprocessing the entries. Repeated occurrences from the same exhibitors may result in their being put on a CASH ONLY basis.

Entry Fee will not be refunded in the event that a dog is absent, disqualified, excused by Veterinarian or judge or barred from competition by action of the Show Committee.

Exhibitors should follow their veterinarian's recommendation to assure their dogs are free of internal and external parasites, any communicable diseases and have appropriate vaccinations.

No entry fees will be refunded if the Show cannot open or be completed by reason of riots, civil disturbances, fire, extreme and/or dangerous weather conditions, an Act of God, public emergency, act of a public enemy, strikes or any other cause beyond the control of the Club or the Superintendent.

The show giving Club, the Show Superintendent, their agents, employees, etc, assume no responsibility for any loss, damage or injury sustained by exhibitors, handlers, or to any of their dogs or property and further assume no responsibility for injury to children.

No entry shall be made and no entry shall be accepted which specifies any condition as to its acceptance. Entries will not be accepted without fees, signatures or the "Agreement" on the reverse side of the Official AKC Entry Form.

Changes, additions or corrections to entry forms must be received in writing prior to close of entries. Those received by telephone are not acceptable.

Refunds of \$4.00 & less will not be issued due to the costs of processing.

An administrative fee of \$2.50 will be charged for all cancellations or changes made prior to closing of entries.

EXHIBITORS NOTE: Please notify Superintendent of any change of address.

Each Entry processed through Jack Onofrio Dog Shows Telephone Entry Service or Onofrio Online Entry will have a service fee included in the amount charged to the payment card provided. Each user of either service acknowledges they are authorized to charge fees to the card provided for payment and further acknowledges the transaction is made over the phone or internet. Chargebacks on cards are a violation of the agreement to pay all fees included in this premium list and can result in the club refusing future entries from the exhibitor, refusal of entries from the exhibitor by the superintendent until the debt has been paid and/or being placed on a cash only basis with the superintendent.

FAX/EMAIL ENTRIES AND PAPER ENTRIES WITH CREDIT CARD ARE NOT ACCEPTABLE METHODS FOR ENTRIES AND WILL NOT BE PROCESSED. Online Entries and Checks by Mail are not affected by this change. If mailing be sure to have the entry with check enclosed arrive prior to the closing date of the show. Please note all entries received via fax or email and/or paper entries with credit card information will be shredded/deleted immediately upon delivery without processing. With credit card security and identity theft concerns we are implementing this change to protect your information from potential abuse. Entry forms are occasionally viewed by others outside of the staff of the Superintendent. We will always be happy to accept entries with payment by check at any of our shows. Stop by and say hello.

Jack Onofrio Dog Shows Telephone Entry Service phone number (405) 427-0405 or toll free (888) 421-0405: This is for Telephone Entry Service ONLY. For Mastercard/Discover/Visa/American Express cardholders. A \$5.05 charge will be added to each entry for use of this service. Mon, Tues, Thurs & Fri 8:00 am to 4:30 pm; Wed 8:00 am to 12:00 noon.

Onofrio Online Entry at www.onofrio.com for entries made with Mastercard/Discover/Visa/American Express. A **nonrefundable** \$3.30 charge will be added to each entry for use of this service.

Special Delivery & Overnight Delivery Mail Address: 3401 NE 23rd St, Oklahoma City, Oklahoma 73121-2447 **FOR SPECIAL & OVERNIGHT DELIVERY MAIL ONLY!**

ALL BREED DOG SHOWS

ILLINOIS VALLEY

KENNEL CLUB OF PEORIA, INC.

Member of the American Kennel Club

FRIDAY

BEST IN SHOW & VARIETY GROUP PRIZES

FOR BEST IN SHOW

\$100 VENDOR BUCKS (not redeemable for cash) & ROSETTE
Offered by the Illinois Valley Kennel Club of Peoria, Inc.

FOR RESERVE BEST IN SHOW

\$50 VENDOR BUCKS (not redeemable for cash)
Offered by Steve & Sue Mahany, Dane Lane Great Danes
ROSETTE
Offered by the Illinois Valley Kennel Club of Peoria, Inc.

FOR BEST OWNER-HANDLED IN SHOW

\$100 VENDOR BUCKS (not redeemable for cash)
Offered by Becky Haberbusch
ROSETTE
Offered by the Illinois Valley Kennel Club of Peoria, Inc.

FOR RESERVE BEST OWNER-HANDLED IN SHOW

\$50 VENDOR BUCKS (not redeemable for cash)
Offered by Beth Rast
ROSETTE
Offered by the Illinois Valley Kennel Club of Peoria, Inc.

FOR FIRST, SECOND, THIRD & FOURTH IN EACH REGULAR VARIETY GROUP

ROSETTE
Offered by the Illinois Valley Kennel Club of Peoria, Inc.

FOR FIRST, SECOND, THIRD & FOURTH IN EACH OWNER-HANDLED VARIETY GROUP

ROSETTE
Offered by the Illinois Valley Kennel Club of Peoria, Inc.

BREED PRIZES

The HEART OF ILLINOIS CLUSTER SHOWS offers a Rosette for Best of Breed/Variety in every breed or variety of breed where the classes are a Supported Entry, unless otherwise offered.

SPORTING BREEDS

BRITTANYS

THE HEART OF ILLINOIS BRITTANY CLUB SUPPORTS THE ENTRY OF ITS BREED AT THIS SHOW.

WORKING BREEDS

GREAT DANES

THE ILLINI GREAT DANE CLUB SUPPORTS THE ENTRY OF ITS BREED AT THIS SHOW

The Illini Great Dane Club offers a 3-Streamer Rosette for Best of Winners, Best of Opposite

Sex to Best of Breed, Select Dog, Select Bitch, Winners Dog, and Winners Bitch.

NEWFOUNDLANDS

BEST OF BREED - \$10 Vendor Bucks (not redeemable for cash) offered by Margot Duval
BEST OF OPPOSITE SEX TO BEST OF BREED - \$10 Vendor Bucks (not redeemable for cash) offered by Rita & David Jacobs, Jaquist Newfoundlands

WINNERS DOG - \$10 Vendor Bucks (not redeemable for cash) offered by Margot Duval
WINNERS BITCH - \$10 Vendor Bucks (not redeemable for cash) offered by Margot Duval
BEST OWNER-HANDLED - \$10 Vendor Bucks (not redeemable for cash) offered by Rita & David Jacobs, Jaquist Newfoundlands

STANDARD SCHNAUZERS

THE PRAIRIELAND STANDARD SCHNAUZER CLUB OF CENTRAL ILLINOIS SUPPORTS THE ENTRY OF ITS BREED AT THIS SHOW.

The following prizes are offered by the Prairieland Standard Schnauzer Club of Central Illinois.

BEST OF BREED - Rosette, Elevated Dog Bed & Blanket
BEST OF OPPOSITE SEX TO BEST OF BREED - Rosette, Elevated Dog Bed & Blanket
BEST OWNER-HANDLED - Rosette, Elevated Dog Bed & Blanket
SELECT DOG - Rosette & Dog Mat
SELECT BITCH - Rosette & Dog Mat
WINNERS DOG - Rosette, Elevated Dog Bed & Blanket
WINNERS BITCH - Rosette, Elevated Dog Bed & Blanket

TERRIER BREEDS

BULL TERRIERS (COLORED, WHITE)

THE FORT DEARBORN BULL TERRIER CLUB SUPPORTS THE ENTRY OF ITS BREED AT THIS SHOW.

The following prizes are a Biothane Slip Lead offered by the Fort Dearborn Bull Terrier Club.

BEST OF VARIETY
BEST OF WINNERS
BEST OF OPPOSITE SEX TO BEST OF VARIETY
WINNERS DOG
RESERVE WINNERS DOG
WINNERS BITCH
RESERVE WINNERS BITCH

MINIATURE BULL TERRIERS

THE MINIATURE BULL TERRIER CLUB OF AMERICA SUPPORTS THE ENTRY OF ITS BREED AT THIS SHOW

The following prizes will be Fleece Blankets offered by Sally Kilkenny for Best of Breed, Best of Opposite Sex to Best of Breed, Winners Dog, Reserve Winners Dog, Winners Bitch, and Reserve Winners Bitch

TOY BREEDS

PEKINGESE

THE NORTH CENTRAL ILLINOIS PEKINGESE CLUB SUPPORTS THE ENTRY OF ITS BREED AT THIS SHOW

NON-SPORTING BREEDS

BULLDOGS

SWEEPSTAKES

REQUIREMENTS & CLASSIFICATION

Dogs shown in Sweepstakes must also be entered in one of the regular classes at the regular entry fee and on the regular entry form. Indicate your Sweepstakes Class with the age division in the space provided for "Additional Class."

The following classes will be provided for both dogs and bitches.

Puppy, 6 Mos & Under 9 Mos • Puppy, 9 Mos & Under 12 Mos • Junior, 12 Mos & Under 18 Mos

DIVISION OF ENTRY MONEY AS PRIZES

35% of total entry fees will be retained by the All Breed Club for expenses. The remaining 65% will be divided as follows: 1st - 40% • 2nd - 30% • 3rd - 20% • 4th - 10%

JUNIOR SHOWMANSHIP COMPETITION PRIZES

The following prizes are offered by the Illinois Valley Kennel Club of Peoria, Inc. unless otherwise specified

BEST JUNIOR HANDLER - \$50.00 Vendor Bucks (not redeemable for cash) offered by Michelle Rowland

BEST JUNIOR HANDLER - Rosette

RESERVE BEST JUNIOR HANDLER - \$25 Vendor Bucks (not redeemable for cash) offered by Michelle Rowland

RESERVE BEST JUNIOR HANDLER - Rosette

FIRST, SECOND, THIRD & FOURTH IN EACH CLASS - Rosette

SUNDAY

BEST IN SHOW & VARIETY GROUP PRIZES

FOR BEST IN SHOW

\$100 VENDOR BUCKS (not redeemable for cash) & ROSETTE
Offered by the Illinois Valley Kennel Club of Peoria, Inc.

FOR RESERVE BEST IN SHOW

\$50 VENDOR BUCKS (not redeemable for cash)
Offered by Steve & Sue Mahany, Dane Lane Great Danes
ROSETTE

Offered by the Illinois Valley Kennel Club of Peoria, Inc.

FOR BEST OWNER-HANDLED IN SHOW

\$100 VENDOR BUCKS (not redeemable for cash) & ROSETTE
Offered by the Illinois Valley Kennel Club of Peoria, Inc.

FOR RESERVE BEST OWNER-HANDLED IN SHOW

\$50 VENDOR BUCKS (not redeemable for cash)
Offered by Steve & Debbie Melgreen, Melridge Kennel
ROSETTE

Offered by the Illinois Valley Kennel Club of Peoria, Inc.

FOR BEST 4-6 MONTH BEGINNER PUPPY IN SHOW

\$25 VENDOR BUCKS (not redeemable for cash)
Offered by Beth Rast
ROSETTE

Offered by the Illinois Valley Kennel Club of Peoria, Inc.

FOR FIRST, SECOND, THIRD & FOURTH IN EACH REGULAR VARIETY GROUP

ROSETTE
Offered by the Illinois Valley Kennel Club of Peoria, Inc.

FOR FIRST, SECOND, THIRD & FOURTH IN EACH OWNER-HANDLED VARIETY GROUP

ROSETTE
Offered by the Illinois Valley Kennel Club of Peoria, Inc.

FOR FIRST, SECOND, THIRD & FOURTH IN EACH 4-6 MONTH BEGINNER PUPPY VARIETY GROUP

ROSETTE
Offered by the Illinois Valley Kennel Club of Peoria, Inc.

BREED PRIZES

The HEART OF ILLINOIS CLUSTER SHOWS offers a Rosette for Best of Breed/Variety in every breed or variety of breed where the classes are a Supported Entry or Designated

Specialty, unless otherwise offered.

The Heart of Illinois Cluster offers a Rosette for Best in Sweepstakes in every breed or Variety where a sweepstakes is offered unless otherwise offered.

SPORTING BREEDS

BRITTANYS

DESIGNATED SPECIALTY

THE HEART OF ILLINOIS BRITANNY CLUB CONSIDERS THE CLASSES AT THIS SHOW AS ITS SPECIALTY SHOW.

OFFICERS

- Chris Logan • President
 - Dave Johnson • 1st Vice President
 - Felicity Britt • 2nd Vice President
 - Lou Hennenfent • 3rd Vice President
 - Todd Parmenter • Treasurer
 - Bradford Bucklin • Secretary
- 984 Clocktower Dr, Ste A, Springfield IL 62704
 Chris Logan • Show Chairman
 220 Wood River Ave, East Alton IL 62026 • (618) 798-1818

SWEEPSTAKES

REQUIREMENTS & CLASSIFICATION

Dogs shown in Sweepstakes must also be entered in one of the regular classes at the regular entry fee and on the regular entry form. Indicate your Sweepstakes Class with the age division in the space provided for "Additional Class."

The following classes will be provided for both dogs and bitches.

- Puppy, 6 Mos & Under 9 Mos • Puppy, 9 Mos & Under 12 Mos • Junior, 12 Mos & Under 18 Mos

DIVISION OF ENTRY MONEY AS PRIZES

35% of total entry fees will be retained by the All Breed Club for expenses. The remaining 65% will be divided as follows: Best in Sweepstakes - 10%; Best of Opposite Sex to Best in Sweepstakes - 5%.

The remaining 50% will be divided as follows:

	1st	2nd	3rd	4th	
4 or more entries	40%	30%	20%	10%	of entry fees for that class
3 entries	50%	30%	20%		of entry fees for that class
2 entries	60%	40%			of entry fees for that class
1 entry	100%				of entry fees for that class

SWEEPSTAKES PRIZES

The Heart of Illinois Brittany Club offers a Rosette for Best in Sweepstakes & Best of Opposite Sex to Best in Sweepstakes.

VETERAN SWEEPSTAKES

REQUIREMENTS & CLASSIFICATION

Dogs shown in Veteran Sweepstakes need not be entered in one of the regular classes or at the regular entry fee. Indicate your Veteran Sweepstakes Class with the age division in the space provided. Spayed bitches & neutered dogs may be shown.

The following classes will be provided for both dogs and bitches.

- Veteran, 7 Yrs & Under 10 Yrs • Veteran, 10 Yrs & Older

DIVISION OF ENTRY MONEY AS PRIZES

35% of total entry fees will be retained by the All Breed Club for expenses. The remaining 65% will be divided as follows: Best in Veteran Sweepstakes - 10%; Best of Opposite Sex to Best in Veteran Sweepstakes - 5%.

The remaining 50% will be divided as follows:

	1st	2nd	3rd	4th	
4 or more entries	40%	30%	20%	10%	of entry fees for that class

3 entries	50%	30%	20%	of entry fees for that class
2 entries	60%	40%		of entry fees for that class
1 entry	100%			of entry fees for that class

VETERAN SWEEPSTAKES PRIZES

The Heart of Illinois Brittany Club offers a Rosette for Best in Veteran Sweepstakes & Best of Opposite Sex to Best in Veteran Sweepstakes.

BREED PRIZES

The Heart of Illinois Brittany Club offers a Rosette for Best of Winners, Best of Opposite Sex to Best of Breed, Winners Dog, Winners Bitch, Select Dog & Select Bitch. The Heart of Illinois Brittany Club offers the following prizes

BEST OF BREED - \$25 Vendor Bucks (not redeemable for cash) Coupons

BEST OF OPPOSITE SEX TO BEST OF BREED - \$10 Vendor Bucks (not redeemable for cash) Coupons

WINNERS DOG - \$10 Vendor Bucks (not redeemable for cash) Coupons

WINNERS BITCH - \$10 Vendor Bucks (not redeemable for cash) Coupons

AWARDS OF MERIT

Awards of Merit may be given at the judge's discretion. The Awards of Merit will be selected after the Best of Breed, Best of Winners, Best of Opposite Sex to Best of Breed, Select Dog & Select Bitch awards are made. All other dogs remaining in competition are eligible for an Award of Merit. The number of Awards of Merit is determined by the size of the entry in competition for Best of Breed. One AOM may be awarded for every 10 dogs competing in the Best of Breed Class. Each AOM winner will receive a Rosette offered by the Heart of Illinois Brittany Club.

WIREHAISED VIZSLAS

THE WIREHAISED VIZSLA CLUB OF AMERICA SUPPORTS THE ENTRY OF ITS BREED AT THIS SHOW.

SWEEPSTAKES REQUIREMENTS & CLASSIFICATION

Dogs shown in Sweepstakes must also be entered in one of the regular classes at the regular entry fee and on the regular entry form. Indicate your Sweepstakes Class with the age division in the space provided for "Additional Class."

The following classes will be provided for both dogs and bitches.

Puppy, 6 Mos & Under 9 Mos • Puppy, 9 Mos & Under 12 Mos

Junior, 12 Mos & Under 18 Mos

DIVISION OF ENTRY MONEY AS PRIZES

35% of total entry fees will be retained by the All Breed Club for expenses. The remaining 65% will be divided as follows: Best in Sweepstakes - 10%; Best of Opposite Sex to Best in Sweepstakes - 5%.

The remaining 50% will be divided as follows:

	1st	2nd	3rd	4th
4 or more entries	40%	30%	20%	10% of entry fees for that class
3 entries	50%	30%	20%	of entry fees for that class
2 entries	60%	40%		of entry fees for that class
1 entry	100%			of entry fees for that class

SWEEPSTAKES PRIZES

The WIREHAISED VIZSLA CLUB OF AMERICA offers a Rosette for Best in Sweepstakes, Best of Opposite Sex to Best in Sweepstakes & First in each Class. The Wirehaired Vizsla Club of America offers the following prizes

BEST IN SWEEPSTAKES - Breed Related Item (Value \$30.00)

BEST OF OPPOSITE SEX TO BEST IN SWEEPSTAKES - Breed Related Item (Value \$20.00)

VETERAN SWEEPSTAKES REQUIREMENTS & CLASSIFICATION

Dogs shown in Veteran Sweepstakes need not be entered in one of the regular classes or at the regular entry fee. Indicate your Veteran Sweepstakes Class with the age division in the space provided. Spayed bitches & neutered dogs may be shown.

The following classes will be provided for both dogs and bitches.

Veteran, 7 Yrs & Under 10 Yrs • Veteran, 10 Yrs & Older

DIVISION OF ENTRY MONEY AS PRIZES

35% of total entry fees will be retained by the All Breed Club for expenses. The remaining 65% will be divided as follows: Best in Veteran Sweepstakes - 10%; Best of Opposite Sex to Best in Veteran Sweepstakes - 5%.

The remaining 50% will be divided as follows:

	1st	2nd	3rd	4th
4 or more entries	40%	30%	20%	10% of entry fees for that class
3 entries	50%	30%	20%	of entry fees for that class
2 entries	60%	40%		of entry fees for that class
1 entry	100%			of entry fees for that class

VETERAN SWEEPSTAKES PRIZES

The Wirehaired Vizsla Club of America offers a Rosette for Best in Veteran Sweepstakes, Best of Opposite Sex to Best in Veteran Sweepstakes & First in each Class. The Wirehaired Vizsla Club of America offers the following prizes

BEST IN VETERAN SWEEPSTAKES - Breed Related Item (Value \$30.00)

BEST OF OPPOSITE SEX TO BEST IN VETERAN SWEEPSTAKES - Breed Related Item (Value \$20.00)

BREED PRIZES

Seraphim Wirehaired Vizslas offers a Rosette for Best of Breed, Best of Winners, Best of Opposite Sex to Best of Breed, Select Dog, Select Bitch, Winners Dog, Reserve Winners Dog, Winners Bitch, Reserve Winners Bitch & First in Each Class. The Wirehaired Vizsla Club of America offers a Breed Related Item.

BEST OF BREED - Value \$50

BEST OF WINNERS - Value \$30

BEST OF OPPOSITE SEX TO BEST OF BREED - Value \$50

SELECT DOG - Value \$30

SELECT BITCH - Value \$30

WINNERS DOG - Value \$25

WINNERS BITCH - Value \$25

BEST OWNER-HANDLED - Value \$20

HOUND BREEDS

DACHSHUNDS (LONGHAIRD)

BEST OF VARIETY - Candy Dish offered by Steve & Debbie Melgreen, Melridge Kennel

DACHSHUNDS (SMOOTH)

BEST OF VARIETY - Dachshund Planter offered by Steve & Debbie Melgreen, Melridge Kennel

DACHSHUNDS (WIREHAIRD)

BEST OF VARIETY - Candy Dish offered by Steve & Debbie Melgreen, Melridge Kennel

WORKING BREEDS

GREAT DANES

THE ILLINI GREAT DANE CLUB SUPPORTS THE ENTRY OF ITS BREED AT THIS SHOW.

The Illini Great Dane Club offers a 3-Streamer Rosette for Best of Winners, Best of Opposite Sex to Best of Breed, Select Dog, Select Bitch, Winners Dog, and Winners Bitch.

NEWFOUNDLANDS

BEST OF BREED - \$10 Vendor Bucks (not redeemable for cash) offered by Margot Duval
BEST OF OPPOSITE SEX TO BEST OF BREED - \$10 Vendor Bucks (not redeemable for cash) offered by Rita & David Jacobs, Jaquist Newfoundland
WINNERS DOG - \$10 Vendor Bucks (not redeemable for cash) offered by Margot Duval
WINNERS BITCH - \$10 Vendor Bucks (not redeemable for cash) offered by Margot Duval
BEST OWNER-HANDLED - \$10 Vendor Bucks (not redeemable for cash) offered by Rita & David Jacobs, Jaquist Newfoundland

STANDARD SCHNAUZERS

DESIGNATED SPECIALTY

**THE PRAIRIELAND STANDARD SCHNAUZER CLUB OF CENTRAL ILLINOIS
CONSIDERS THE CLASSES AT THIS SHOW AS ITS SPECIALTY SHOW.**

OFFICERS

- Connie Reidner • President
 - Marsha Landers • Vice President
 - Kathy Koehler • Treasurer
 - Lynne Conder • Secretary
- 1402 Towanda Ave, Bloomington IL 61704 • (309) 662-7490
Diane Kachur • Show Chairman
1316 Crownpoint Ct, Bloomington IL 61704

BOARD OF DIRECTORS

Diane Kachur • Thomas Mair • Don Kachur

**SWEEPSTAKES
REQUIREMENTS & CLASSIFICATION**

Dogs shown in Sweepstakes must also be entered in one of the regular classes at the regular entry fee and on the regular entry form. Indicate your Sweepstakes Class with the age division in the space provided for "Additional Class."

Eligibility: The Sweepstakes shall be open to any Standard Schnauzer eligible for competition in one of the regular AKC classes & must also be entered in a regular class at a regular fee & whose age will be no less than 6 months & no greater than 18 months on the day of the show.

The only exceptions to this rule are as follows:

1. Champions - No dog which has completed the requirements for a Champion of Record prior to the date of judging shall compete in the Sweepstakes. For the purpose of these rules, the date of record for the Champion of Record shall be the date of the show at which the dog won its final points.
2. Handlers - No dog may be handled in a Sweepstakes Class by a professional handler (one who realizes monetary gain from showing dogs) unless the handler is the registered owner of the dog.
3. Ineligible Dogs - Should it be found that an ineligible dog has received an award in the Sweepstakes, money & other awards shall then be redistributed to conform to the rules. The person to whom such award was presented shall make restitution to the Club & such award shall be deemed to have been won by the dog judged second to the dog declared ineligible.

The following classes will be provided for both dogs and bitches.
Junior, 6 Mos & Under 9 Mos • Junior, 9 Mos & Under 12 Mos
Senior, 12 Mos & Under 15 Mos • Senior, 15 Mos & Under 18 Mos

DIVISION OF ENTRY MONEY AS PRIZES

35% of total entry fees will be retained by the All Breed Club for expenses. The remaining 65% will be divided as follows: Best in Sweepstakes - 10%; Best of Opposite Sex to Best in Sweepstakes - 5%.

The remaining 50% will be divided as follows:

	1st	2nd	3rd	4th	
4 or more entries	40%	30%	20%	10%	of entry fees for that class
3 entries	50%	30%	20%		of entry fees for that class
2 entries	60%	40%			of entry fees for that class
1 entry	100%				of entry fees for that class

SWEEPSTAKES PRIZES

The Prairieland Standard Schnauzer Club of Central Illinois offers a Rosette for Best in Sweepstakes & Best of Opposite Sex to Best in Sweepstakes.

Best in Sweepstakes - Wood Schnauzer

Best Opposite Sex to Best in Sweepstakes - Wood Schnauzer

1st place in all classes - Toy Basket and Blanket

2nd,, 3rd, 4th in all classes - Dog Toy

VETERAN SWEEPSTAKES REQUIREMENTS & CLASSIFICATION

Dogs shown in Veteran Sweepstakes need not be entered in one of the regular classes or at the regular entry fee. Indicate your Veteran Sweepstakes Class with the age division in the space provided. Altered Standard Schnauzers may be shown in Veteran Sweepstakes Classes.

The following classes will be provided for both dogs and bitches.

Veteran, 7 Yrs & Under 9 Yrs • Veteran, 9 Yrs & Under 11 Yrs • Veteran, 11 Yrs & Older

DIVISION OF ENTRY MONEY AS PRIZES

35% of total entry fees will be retained by the All Breed Club for expenses. The remaining 65% will be divided as follows: Best in Veteran Sweepstakes - 10%; Best of Opposite Sex to Best in Veteran Sweepstakes - 5%.

The remaining 50% will be divided as follows:

	1st	2nd	3rd	4th	
4 or more entries	40%	30%	20%	10%	of entry fees for that class
3 entries	50%	30%	20%		of entry fees for that class
2 entries	60%	40%			of entry fees for that class
1 entry	100%				of entry fees for that class

VETERAN SWEEPSTAKES PRIZES

The Prairieland Standard Schnauzer Club of Central Illinois offers a Rosette for Best in Veteran Sweepstakes & Best of Opposite Sex to Best in Veteran Sweepstakes.

Best in Veteran Sweepstakes - Wood Schnauzer

Best Opposite Sex to Best in Veteran Sweepstakes - Wood Schnauzer

1st place in all classes - Toy Basket and Blanket

2nd,, 3rd, 4th in all classes - Dog Toy

THERE WILL BE COMPETITION FOR BEST BRED-BY-EXHIBITOR

BREED PRIZES

Prairieland Standard Schnauzer Club is celebrating the club's 25th anniversary. The trophies reflect the silver anniversary celebration. The following prizes are offered by Prairieland Standard Schnauzer Club of Central Illinois through the generosity of its members.

The Prairieland Standard Schnauzer Club of Central Illinois offers a Rosette for Best of Breed, Best of Winners, Best of Opposite Sex to Best of Breed, Select Dog, Select Bitch, Winners Dog, Reserve Winners Dog, Winners Bitch, Reserve Winners Bitch, Best Owner-Handled, Best Bred-By-Exhibitor & First in Each Non-Regular Class.

Best of Breed - Folding Stool commemorating the club's 25th anniversary. plaque commemorating name added to William Duffee Memorial Trophy.

Best of Winners - Folding Stool commemorating the club's 25th anniversary

Best of Opposite Sex to Best of Breed - Folding Stool commemorating the club's 25th anniversary, plaque commemorating name added to Robert Weigel Memorial trophy

NOHS Best of Breed - Folding Stool commemorating the club's 25th anniversary

Select Dog - Large Treat Jar with Silver Lid

Select Bitch - Large Treat Jar with Silver Lid

Winners Dog - 8 x 10 Silver Schnauzer Silhouette

Reserve Winners Dog - 5 x 7 Silver Schnauzer Silhouette

Winners Bitch - 8 x 10 Silver Schnauzer Silhouette

Reserve Winners Bitch - 5 x 7 Silver Schnauzer Silhouette

Best Bred-by-Exhibitor - Wood Box with Silver Schnauzer Silhouette

Veteran Dog Class, 1st - 5 x 7 Silver Schnauzer Silhouette
Veteran Bitch Class, 1st - 5 x 7 Silver Schnauzer Silhouette
Stud Dog Class, 1st - Toy Basket and Blanket
Brood Bitch Class, 1st - Toy Basket and Blanket
Brace Class, 1st - Toy Basket and Blanket
All placings in all classes - Commemorative Paperweight

AWARDS OF MERIT

Awards of Merit may be given at the judge's discretion. The Awards of Merit will be selected after Best of Breed, Best of Winners and Best of Opposite Sex to Best of Breed awards are made. All other dogs remaining in competition are eligible for an Award of Merit. The number of Awards of Merit is determined by the size of the entry in competition for Best of Breed. One AOM may be awarded for every 10 dogs competing in the Best of Breed class. Each AOM will receive a Rosette offered by the Prairieland Standard Schnauzer Club of Central Illinois and Small Treat Jar with Silver Lid through the generosity of members

We are planning a blood draw during the weekend for DCM testing and DNA bank for Standard Schnauzers only. If you are interested, please be sure to bring registration information for dogs to be tested. Dogs do not have to be entered to participate in this clinic. Any questions, please contact Penny Duffee at DuffPnB@aol.com

BANQUET RESERVATIONS

Join Standard Schnauzer fanciers for our annual informal dinner, raffle & silent auction on Sunday evening. Contact Kathy Koehler at KatonSS1@frontier.com for details. Reservations & payment MUST BE RECEIVED by May 6, 2026 (show closing date).

TERRIER BREEDS

BULL TERRIERS (COLORED, WHITE)
THE FORT DEARBORN BULL TERRIER CLUB SUPPORTS THE ENTRY OF ITS BREED AT THIS SHOW.

**SWEEPSTAKES
REQUIREMENTS & CLASSIFICATION**

Dogs shown in Sweepstakes must also be entered in one of the regular classes at the regular entry fee and on the regular entry form. Indicate your Sweepstakes Class with the age division in the space provided for "Additional Class."

The following classes will be provided for both dogs and bitches in each variety.
Puppy, 6 Mos & Under 9 Mos • Puppy, 9 Mos & Under 12 Mos
Junior, 12 Mos & Under 15 Mos • Junior, 15 Mos & Under 18 Mos

DIVISION OF ENTRY MONEY AS PRIZES

35% of total entry fees will be retained by the All Breed Club for expenses. 65% will be divided as follows: Best in Sweepstakes - 10%; Best of Opposite Sex to Best in Sweepstakes - 5%.

The remaining 50% will be divided as follows:

	1st	2nd	3rd	4th	
4 or more entries	40%	30%	20%	10%	of entry fees for that class
3 entries	50%	30%	20%		of entry fees for that class
2 entries	60%	40%			of entry fees for that class
1 entry	100%				of entry fees for that class

SWEEPSTAKES PRIZES

The Fort Dearborn Bull Terrier Club offers a Rosette and Biothane Slip Lead in each variety for Best of Variety in Sweepstakes & Best of Opposite Sex to Best of Variety in Sweepstakes.

BREED PRIZES

The following prizes are Fox & Hound Bull Terrier Items (Value \$ 60) offered by Luna Bull Terriers.

BEST OF VARIETY
 BEST OF WINNERS
 BEST OF OPPOSITE SEX TO BEST OF VARIETY
 WINNERS DOG
 RESERVE WINNERS DOG
 WINNERS BITCH
 RESERVE WINNERS BITCH

MINIATURE BULL TERRIERS
THE MINIATURE BULL TERRIER CLUB OF AMERICA SUPPORTS THE ENTRY OF ITS BREED AT THIS SHOW

TOY BREEDS

PEKINGESE

DESIGNATED SPECIALTY

THE NORTH CENTRAL ILLINOIS PEKINGESE CLUB CONSIDERS THE CLASSES AT THIS SHOW AS ITS SPECIALTY SHOW.

OFFICERS

Christa Schonscheck • President
 Barb Stroomke • Vice President
 Christine Hann • Treasurer
 Vincent Fleece • Secretary
 3103 Hillier Rd, Norton, OH 44203
 Vincent Fleece • Show Chairman
 3103 Hillier Rd, Norton, OH 44203

BOARD OF DIRECTORS

Lenore Chemers • Dawn Krautkremer • Connie Bullock • Deb Thompson

SWEEPSTAKES REQUIREMENTS & CLASSIFICATION

Dogs shown in Sweepstakes must also be entered in one of the regular classes at the regular entry fee and on the regular entry form. Indicate your Sweepstakes Class with the age division in the space provided for "Additional Class."

The following classes will be provided for both dogs and bitches.
 Puppy, 6 Mos & Under 9 Mos • Puppy, 9 Mos & Under 12 Mos
 Junior, 12 Mos & Under 15 Mos • Junior, 15 Mos & Under 18 Mos

DIVISION OF ENTRY MONEY AS PRIZES

35% of total entry fees will be retained by the All Breed Club for expenses. 65% will be divided as follows: Best in Sweepstakes - 10%; Best of Opposite Sex to Best in Sweepstakes - 5%.

The remaining 50% will be divided as follows:

	1st	2nd	3rd	4th	
4 or more entries	40%	30%	20%	10%	of entry fees for that class
3 entries	50%	30%	20%		of entry fees for that class
2 entries	60%	40%			of entry fees for that class
1 entry	100%				of entry fees for that class

SWEEPSTAKES PRIZES

The NORTH CENTRAL ILLINOIS PEKINGESE CLUB offers a Rosette for Best in Sweepstakes & Best of Opposite Sex to Best in Sweepstakes.
BEST IN SWEEPSTAKES - \$25.00 offered by Barbara Stemke, Primapekes

THERE WILL BE COMPETITION FOR BEST PUPPY IN PUPPY CLASSES & BEST BRED-BY-EXHIBITOR

REGULAR CLASS PRIZES

The North Central Pekingese Club offers a Rosette for Best of Breed, Best of Winners, Best of Opposite Sex to Best of Breed, Select Dog, Select Bitch, Winners Dog, Reserve Winners Dog, Winners Bitch, Reserve Winners Bitch, Best Owner-Handled, Best Puppy in Puppy Classes, Best Bred-By-Exhibitor, Stud Dog Class, 1st, Brood Bitch Class 1st, & Brace Class, 1st.
 The following prizes are offered by Barbara Stemke, Primapekes.

BEST OF BREED - \$125.00
BEST OF WINNERS - \$100.00
BEST OF OPPOSITE SEX TO BEST OF BREED - \$75.00
WINNERS DOG - \$62.50
RESERVE WINNERS DOG - \$25.00
WINNERS BITCH - \$62.50
RESERVE WINNERS BITCH - \$25.00

AWARDS OF MERIT

Awards of Merit may be given at the judge's discretion. The Awards of Merit will be selected after the Best of Breed, Best of Winners, Best of Opposite Sex to Best of Breed, Select Dog and Select Bitch awards are made. All other dogs remaining in competition are eligible for Awards of Merit. The number of Awards of Merit is determined by the size of the entry in competition for Best of Breed: 1-5 entries = 1 AOM; 6-10 = 2 AOM; 11-15 = 3 AOM; 16-20 = 4 AOM; 21 and over = 5 AOM. Winners will receive a Rosette offered by the North Central Illinois Pekingese Club.

JUNIOR SHOWMANSHIP COMPETITION PRIZES

The following prizes are offered by the Illinois Valley Kennel Club of Peoria, Inc. unless otherwise specified

BEST JUNIOR HANDLER - \$50 Vendor Bucks (not redeemable for cash) offered by Michelle Rowland

BEST JUNIOR HANDLER - Rosette

RESERVE BEST JUNIOR HANDLER - \$25 Vendor Bucks (not redeemable for cash) offered by Michelle Rowland

RESERVE BEST JUNIOR HANDLER - Rosette

FIRST, SECOND, THIRD & FOURTH IN EACH CLASS - Rosette



The following prizes are offered by the Junior Achievement Challenge.

FIRST IN EACH CLASS - 1 Group of AKC Breed Standards (Junior's Choice)

Concurrent Specialty Shows

Allows exhibitors the opportunity to exhibit twice on one day.

136th & 137th CHICAGO BULLDOG CLUB, INC.

136th Specialty Show on Saturday following Corn Belt Kennel Club, Inc. Bulldogs
137th Specialty Show on Sunday following Illinois Valley Kennel Club of Peoria, Inc. Bulldogs
Limited to 100 Entries per Show



Member of the American Kennel Club

SATURDAY, MAY 23, 2026

SUNDAY, MAY 24, 2026

Show Hours: 8:00 am - 6:00 pm

OFFICERS

- | | |
|-----------------------|-------------------------|
| Mrs Kelley Ensminger | • President |
| Mr John J Leadroot Jr | • First Vice President |
| Mr Kevin Beatty | • Second Vice President |
| Ms Janet Klopp | • Treasurer |
| Mrs Jennifer Guinn | • Secretary |
- 381 N Edgewood Ave, Wood Dale IL 60191

DELEGATE TO THE AMERICAN KENNEL CLUB

Cathy Eke

BOARD OF DIRECTORS

Sandra Ballwanz • Rachel Garde • Bruce Iehl • Jennifer Guinn

SHOW COMMITTEE

Janet Klopp • Show Chairman

3778 Canton Cir, Mundelein IL 60060-6035 • (224) 406-2440 • janeltklopp@gmail.com

Officers of the Club & Members of the Board of Directors

COMMITTEES

- | | |
|--|----------------------------|
| Mrs Kelley Ensminger & Ms Janet Klopp | • Trophies, Awards & Gifts |
| Mrs Kelley Ensminger, Rachel Garde
& Club Members | • Hospitality |
| Mrs Jennifer Guinn | • Mentoring |
| Mrs Kelley Ensminger, Ms Janet Klopp
& Club Members | • Ways & Means |
| Julia Abell | • Chief Ring Steward |

SATURDAY JUDGE

Regular & Non-Regular Classes

Karen M Zimny* - Waseca MN

SUNDAY JUDGE

Regular & Non-Regular Classes

Dr M Patricia Joyce* - Tucker GA

** One or more breed assigned approved as provisional/permit by AKC*

SATURDAY BREED PRIZES

The Chicago Bulldog Club, Inc. through the generosity of its members offers a Rosette for Best of Breed, Best of Winners, Best of Opposite Sex to Best of Breed, Winners Dog, Reserve Winners Dog, Winners Bitch, Reserve Winners Bitch, Best Puppy in Puppy Classes & First in Each Class.

SUNDAY BREED PRIZES

The Chicago Bulldog Club, Inc. through the generosity of its members offers a Rosette for Best of Breed, Best of Winners, Best of Opposite Sex to Best of Breed, Winners Dog, Reserve Winners Dog, Winners Bitch, Reserve Winners Bitch, Best Puppy in Puppy Classes & First in Each Class.

THERE WILL BE BEST PUPPY COMPETITION

During the course of Regular judging, the assigned judge will select a Best Puppy from the Class winners of the 6 mos. and under 9 mos. and the 9 mos. and under 12 mos. and Bred-by-Exhibitor Puppy. 6 mos & under 12 Mos. Classes. This will be done after the Best of Breed Competition judging unless the Best Puppy award is automatic. Example: An entry from the Puppy Classes are awarded Best of Winners or Best of Breed. Only dogs and bitches undefeated in a Puppy Class are eligible for Best Puppy Competition. If the first place winner is not present, the second place winner may not compete.

A.M. Continental Breakfast: Juice, Coffee & Pastries.

CHICAGO BULLDOG CLUB HOSPITALITY SATURDAY & SUNDAY

Saturday Luncheon just outside the Show Building.
Come for the show and enjoy Chicago Hospitality.

ALL BREED DOG SHOWS



Incorporated

Member of the American Kennel Club www.cornbeltkennelclub.org

CELEBRATING THE CLUB'S 75TH ANNIVERSARY

SATURDAY, MAY 23, 2026

MONDAY, MAY 25, 2026

SHOW HOURS: 6:00 am to 6:00 pm

CBKC members serving as Show Chairman & members of the Judging Selection Committee shall not enter any dogs solely owned by them or their immediate family members in Conformation, except for Junior Showmanship Classes, at any Corn Belt Kennel Club, Inc. AKC sanctioned show, nor shall they or their immediate family exhibit.

OFFICERS

Karen Lander • President
Darcie Mair • Vice President
David Lander • Treasurer
Penny Duffee • Secretary
8 Chrisman Ln, Bloomington IL 61704

BOARD OF DIRECTORS

Don Kachur • Kathy Karl • Valeri Farmer-Dugan

SHOW COMMITTEE

Darcie Mair • Show Chairman
209 Mecherle Dr, Bloomington, IL 61701
Officers of the Club & Members of the Board of Directors

COMMITTEES

Brenda Matherly & Kathy Koehler • Trophy
Hollie Perez • Hospitality
Thomas Mair • Judges Hospitality
David Lander • Grounds
Club Members • Catalog Sales
Darcie Mair • Junior Showmanship Coordinator
Karen Burge, Stormy Carr, & Rudy Kilgus • RV Parking Coordinators
Valeri Farmer-Dugan • Chief Ring Steward

SATURDAY

BEST IN SHOW & VARIETY GROUP PRIZES

FOR BEST IN SHOW

LARGE ROSETTE, FOLDING STOOL WITH CLUB ANNIVERSARY LOGO & BLANKET
Offered by the Corn Belt Kennel Club, Inc.

FOR RESERVE BEST IN SHOW

LARGE ROSETTE & FOLDING STOOL WITH CLUB ANNIVERSARY LOGO
Offered by the Corn Belt Kennel Club, Inc.

FOR BEST OWNER-HANDLED IN SHOW

LARGE ROSETTE & \$75 CASH
Offered by the Corn Belt Kennel Club, Inc.

FOR RESERVE BEST OWNER-HANDLED IN SHOW

LARGE ROSETTE & \$50 CASH
Offered by the Corn Belt Kennel Club, Inc.

FOR BEST 4-6 MONTH BEGINNER PUPPY IN SHOW

LARGE ROSETTE, TOY BASKET, & \$25 VENDOR BUCKS (not redeemable for cash)
Offered by the Corn Belt Kennel Club, Inc.

FOR FIRST, SECOND, THIRD & FOURTH IN EACH REGULAR VARIETY GROUP

LARGE ROSETTE & TOTE BAG WITH CLUB ANNIVERSARY LOGO
Offered by the Corn Belt Kennel Club, Inc.

FOR FIRST, SECOND, THIRD & FOURTH IN EACH OWNER-HANDLED VARIETY GROUP

ROSETTE & TOTE BAG WITH CLUB ANNIVERSARY LOGO
Offered by the Corn Belt Kennel Club, Inc.

FOR FIRST, SECOND, THIRD & FOURTH IN EACH 4-6 MONTH BEGINNER PUPPY VARIETY GROUP

ROSETTE
Offered by the Corn Belt Kennel Club, Inc.

BREED PRIZES

COMMEMORATIVE PEN FOR EVERY BREED

The HEART OF ILLINOIS CLUSTER SHOWS offers a Rosette for Best of Breed/Variety in every breed or variety of breed where the classes are a Supported Entry, unless otherwise offered.

The HEART OF ILLINOIS CLUSTER SHOWS offers a Rosette for Best in Sweepstakes in every breed or variety where a sweepstakes is offered, unless otherwise offered.

SPORTING BREEDS

BRITTANYS

THE HEART OF ILLINOIS BRITTANY CLUB SUPPORTS THE ENTRY OF ITS BREED AT THIS SHOW.

WORKING BREEDS

GREAT DANES

THE ILLINI GREAT DANE CLUB SUPPORTS THE ENTRY OF ITS BREED AT THIS SHOW.

The Illini Great Dane Club offers a 3-Streamer Rosette for Best of Breed, Best of Winners, Best of Opposite Sex to Best of Breed, Select Dog, Select Bitch, Winners Dog, Winners Bitch.

STANDARD SCHNAUZERS
THE HEARTLAND STANDARD SCHNAUZER CLUB OF GREATER TWIN CITIES
SUPPORTS THE ENTRY OF ITS BREED AT THIS SHOW.

The following prizes are offered by the Heartland Standard Schnauzer Club of Greater Twin Cities.

- BEST OF BREED - Rosette & Embroidered Towel
- BEST OF OPPOSITE SEX TO BEST OF BREED - Rosette & Embroidered Towel
- BEST OWNER-HANDLED - Rosette & Embroidered Towel
- SELECT DOG - Rosette & Embroidered Towel
- SELECT BITCH - Rosette & Embroidered Towel
- WINNERS DOG - Rosette & Embroidered Towel
- WINNERS BITCH - Rosette & Embroidered Towel

TERRIER BREEDS

BULL TERRIERS (COLORED, WHITE)

SWEEPSTAKES

REQUIREMENTS & CLASSIFICATION

Dogs shown in Sweepstakes must also be entered in one of the regular classes at the regular entry fee and on the regular entry form. Indicate your Sweepstakes Class with the age division in the space provided for "Additional Class."

The following classes will be provided for both dogs and bitches.
Puppy, 6 Mos & Under 9 Mos • Puppy, 9 Mos & Under 12 Mos
Junior, 12 Mos & Under 15 Mos • Junior, 15 Mos & Under 18 Mos

DIVISION OF ENTRY MONEY AS PRIZES

35% of total entry fees will be retained by the All Breed Club for expenses. The remaining 65% will be divided as follows: Best in Sweepstakes - 10%; Best of Opposite Sex to Best in Sweepstakes - 5%.

The remaining 50% will be divided as follows:

	1st	2nd	3rd	4th	
4 or more entries	40%	30%	20%	10%	of entry fees for that class
3 entries	50%	30%	20%		of entry fees for that class
2 entries	60%	40%			of entry fees for that class
1 entry	100%				of entry fees for that class

SWEEPSTAKES PRIZES

The BULL TERRIER CLUB OF AMERICA offers a Rosette for Best in Sweepstakes and Best of Opposite Sex to Best in Sweepstakes. The following prizes are offered by the Illiniana Bull Terrier Fanciers

- BEST IN SWEEPSTAKES - Glass Jar
- BEST OF OPPOSITE SEX TO BEST IN SWEEPSTAKES - Glass Mug

VETERAN SWEEPSTAKES

REQUIREMENTS & CLASSIFICATION

Dogs shown in Veteran Sweepstakes need not be entered in one of the regular classes or at the regular entry fee. Indicate your Veteran Sweepstakes Class with the age division in the space provided.

The following classes will be provided for both dogs and bitches.
Veteran, 7 Yrs & Older

DIVISION OF ENTRY MONEY AS PRIZES

35% of total entry fees will be retained by the All Breed Club for expenses. The remaining 65% will be divided as follows: Best in Veteran Sweepstakes - 10%; Best of Opposite Sex to Best in Veteran Sweepstakes - 5%.

The remaining 50% will be divided as follows:

	1st	2nd	3rd	4th	
4 or more entries	40%	30%	20%	10%	of entry fees for that class
3 entries	50%	30%	20%		of entry fees for that class

2 entries
1 entry

60% 40%
100%

of entry fees for that class
of entry fees for that class

VETERAN SWEEPSTAKES PRIZES

The BULL TERRIER CLUB OF AMERICA offers a Rosette for Best in Sweepstakes and Best of Opposite Sex to Best in Veteran Sweepstakes. The Illiana Bull Terrier Fanciers offer the following prizes

BEST IN VETERAN SWEEPSTAKES - Glass Jar

BEST OF OPPOSITE SEX TO BEST IN VETERAN SWEEPSTAKES - Glass Mug

BREED PRIZES (BOTH VARIETIES)

The Illiana Bull Terrier Fanciers offers Bull Terrier on Agate for Best of Variety, Best of Opposite Sex to Best of Variety, Winners Dog, Reserve Winners Dog, Winners Bitch and Reserve Winners Bitch.

The following prizes are offered by the Illiana Bull Terrier Fanciers.

For each Variety:

BEST OF VARIETY - Bull Terrier on Agate

BEST OF OPPOSITE SEX TO BEST OF VARIETY - Bull Terrier on Agate

WINNERS DOG - Bull Terrier on Agate

RESERVE WINNERS DOG - Garden Flag

WINNERS BITCH - Bull Terrier on Agate

RESERVE WINNERS - BITCH - Garden Flag

MINIATURE BULL TERRIERS

DESIGNATED SPECIALTY

THE MINIATURE BULL TERRIER CLUB OF AMERICA CONSIDERS THE CLASSES AT THIS SHOW AS ITS SPECIALTY SHOW.

OFFICERS

- Linda Duncan • President
 - Beverly Krautler • 1st Vice President
 - Luis Flores • 2nd Vice President
 - Karin Lamkins • Treasurer
 - Alison Ibbitson • Recording Secretary
 - Dede Wilson • Corresponding Secretary
- 128 January Hill Rd, Amherst, MA 01002

BOARD OF DIRECTORS

Denise Anderson • Kathy Graber

**SWEEPSTAKES
REQUIREMENTS & CLASSIFICATION**

Dogs shown in Sweepstakes must also be entered in one of the regular classes at the regular entry fee and on the regular entry form. Indicate your Sweepstakes Class with the age division in the space provided for "Additional Class."

The following classes will be provided for both dogs and bitches.

- Puppy, 6 Mos & Under 9 Mos • Puppy, 9 Mos & Under 12 Mos
- Junior, 12 Mos & Under 15 Mos • Junior, 15 Mos & Under 18 Mos

DIVISION OF ENTRY MONEY AS PRIZES

35% of total entry fees will be retained by the All Breed Club for expenses. The remaining 65% will be divided as follows: Best in Sweepstakes - 10%; Best of Opposite Sex to Best in Sweepstakes - 5%.

The remaining 50% will be divided as follows:

	1st	2nd	3rd	4th	
4 or more entries	40%	30%	20%	10%	of entry fees for that class
3 entries	50%	30%	20%		of entry fees for that class
2 entries	60%	40%			of entry fees for that class
1 entry	100%				of entry fees for that class

SWEEPSTAKES PRIZES

The MINIATURE BULL TERRIER CLUB OF AMERICA offers a Rosette and Deluxe Toy

offered by Linda Duncan for Best in Sweepstakes and Best of Opposite Sex to Best in Sweepstakes.

**VETERAN SWEEPSTAKES
REQUIREMENTS & CLASSIFICATION**

Dogs shown in Veteran Sweepstakes need not be entered in one of the regular classes or at the regular entry fee. Indicate your Veteran Sweepstakes Class with the age division in the space provided.

The following classes will be provided for both dogs and bitches.
Veteran, 7 Yrs & Older

DIVISION OF ENTRY MONEY AS PRIZES

35% of total entry fees will be retained by the All Breed Club for expenses. The remaining 65% will be divided as follows: Best in Veteran Sweepstakes - 10%; Best of Opposite Sex to Best in Veteran Sweepstakes - 5%.

The remaining 50% will be divided as follows:

	1st	2nd	3rd	4th	
4 or more entries	40%	30%	20%	10%	of entry fees for that class
3 entries	50%	30%	20%		of entry fees for that class
2 entries	60%	40%			of entry fees for that class
1 entry	100%				of entry fees for that class

VETERAN SWEEPSTAKES PRIZES

The MINIATURE BULL TERRIER CLUB OF AMERICA offers a Rosette and Deluxe Toy offered by Linda Duncan for Best in Sweepstakes and Best of Opposite Sex to Best in Veteran Sweepstakes.

BREED PRIZES

The following prizes will be a Bully Ceramic Dish offered by Crissy Brown-Stone & Steve Stone for Best of Breed, Best of Opposite Sex to Best of Breed, Select Dog, Select Bitch, Winners Dog, Reserve Winners Dog, Winners Bitch & Reserve Winners Bitch.

TOY BREEDS

PEKINGESE

DESIGNATED SPECIALTY

THE NORTH CENTRAL ILLINOIS PEKINGESE CLUB CONSIDERS THE CLASSES AT THIS SHOW AS ITS SPECIALTY SHOW.

OFFICERS

- Christa Schumacker • President
- Barb Stroomke • Vice President
- Christine Hann • Treasurer
- Vincent Fleece • Secretary
- 3103 Hillier Rd, Norton, Ohio 44203
- Vincent Fleece • Show Chairman
- 3103 Hillier Rd, Norton, Ohio 44203

BOARD OF DIRECTORS

- Lenore Chemers • Dawn Krautkremer • Connie Bullock • Deb Thompson

**SWEEPSTAKES
REQUIREMENTS & CLASSIFICATION**

Dogs shown in Sweepstakes must also be entered in one of the regular classes at the regular entry fee and on the regular entry form. Indicate your Sweepstakes Class with the age division in the space provided for "Additional Class."

The following classes will be provided for both dogs and bitches.
Puppy, 6 Mos & Under 9 Mos • Puppy, 9 Mos & Under 12 Mos
Junior, 12 Mos & Under 15 Mos • Junior, 15 Mos & Under 18 Mos

DIVISION OF ENTRY MONEY AS PRIZES

35% of total entry fees will be retained by the All Breed Club for expenses. 65% will be divided as follows: Best in Sweepstakes - 10%; Best of Opposite Sex to Best in Sweepstakes - 5%.

The remaining 50% will be divided as follows:

	1st	2nd	3rd	4th	
4 or more entries	40%	30%	20%	10%	of entry fees for that class

3 entries	50%	30%	20%	of entry fees for that class
2 entries	60%	40%		of entry fees for that class
1 entry	100%			of entry fees for that class

SWEEPSTAKES PRIZES

The North Central Illinois Pekingese Club offers a Rosette for Best in Sweepstakes & Best of Opposite Sex to Best in Sweepstakes.

BEST IN SWEEPSTAKES - \$25.00 offered by Barbara Stemke, Primapekes

**THERE WILL BE COMPETITION FOR
BEST PUPPY IN PUPPY CLASSES & BEST BRED-BY-EXHIBITOR**

REGULAR CLASS PRIZES

The North Central Illinois Pekingese Club offers a Rosette for Best of Breed, Best of Winners, Best of Opposite Sex to Best of Breed, Select Dog, Select Bitch, Winners Dog, Reserve Winners Dog, Winners Bitch, Reserve Winners Bitch, Best Owner-Handled, Best Puppy in Puppy Classes, Best Bred-By-Exhibitor, Stud Dog Class, 1st, Brood Bitch Class, 1st & Brace Class, 1st.

The following prizes are offered by Barbara Stemke, Primapekes.

BEST OF BREED - \$125.00

BEST OF WINNERS - \$100.00

BEST OF OPPOSITE SEX TO BEST OF BREED - \$75.00

WINNERS DOG - \$62.50

RESERVE WINNERS DOG - \$25.00

WINNERS BITCH - \$62.50

RESERVE WINNERS BITCH - \$25.00

AWARDS OF MERIT

Awards of Merit may be given at the judge's discretion. The Awards of Merit will be selected after the Best of Breed, Best of Winners, Best of Opposite Sex to Best of Breed, Select Dog & Select Bitch awards are made. All other dogs remaining in competition are eligible for an Award of Merit. The number of Awards of Merit is determined by the size of the entry in competition for Best of Breed: 1-5 entries = 1 AOM; 6-10 = 2 AOM; 11-15 = 3 AOM; 16-20 = 4 AOM; 21 and over = 5 AOM. Winners will receive a Rosette offered by the North Central Illinois Pekingese Club.

JUNIOR SHOWMANSHIP COMPETITION PRIZES

The members of the Corn Belt Kennel Club, Inc. are pleased to support the future education of the Juniors who participate in the Sport of Dogs. These juniors represent the future of our sport.

The Corn Belt Kennel Club, Inc. will offer a \$300.00 Scholarship Certificate for Best Junior Handler & \$200.00 Scholarship Certificate for Reserve Best Junior Handler chosen at this event* (not redeemable for cash). These Scholarships are for one-time scholarship for post-secondary education (not necessarily a college). When the Junior enrolls, the Corn Belt Kennel Club, Inc. will require enrollment confirmation from the Juniors school of choice. The Corn Belt Kennel Club, Inc. will send payment directly to the school for credit to the junior's account.

Should the winning junior not redeem this certificate by age 25 years, the forfeited monies will be placed back into Corn Belt Kennel Club, Inc.'s Scholarship Fund for future use.

* *Scholarship certificates will be awarded provided there is competition for this award. A minimum of 2 class winners must be present to compete for this award.*

BEST JUNIOR HANDLER - Large Rosette offered by the Corn Belt Kennel Club, Inc.

RESERVE BEST JUNIOR HANDLER - Large Rosette offered by the Corn Belt Kennel Club, Inc.



The following prizes are offered by the Junior Achievement Challenge.
FIRST IN EACH CLASS - 1 Group of AKC Breed Standards (Junior's Choice)

MONDAY

BEST IN SHOW & VARIETY GROUP PRIZES

FOR BEST IN SHOW

LARGE ROSETTE, FOLDING STOOL WITH CLUB ANNIVERSARY LOGO & BLANKET
Offered by the Corn Belt Kennel Club, Inc.

FOR RESERVE BEST IN SHOW

LARGE ROSETTE & FOLDING STOOL WITH CLUB ANNIVERSARY LOGO
Offered by the Corn Belt Kennel Club, Inc.

FOR BEST OWNER-HANDLED IN SHOW

LARGE ROSETTE & \$75 CASH
Offered by the Corn Belt Kennel Club, Inc.

FOR RESERVE BEST OWNER-HANDLED IN SHOW

LARGE ROSETTE & \$50 CASH
Offered by the Corn Belt Kennel Club, Inc.

FOR FIRST, SECOND, THIRD & FOURTH IN EACH REGULAR VARIETY GROUP

ROSETTE & TOTE BAG WITH CLUB ANNIVERSARY LOGO
Offered by the Corn Belt Kennel Club, Inc.

FOR FIRST, SECOND, THIRD & FOURTH IN EACH OWNER-HANDLED VARIETY GROUP

ROSETTE & TOTE BAG WITH CLUB ANNIVERSARY LOGO
Offered by the Corn Belt Kennel Club, Inc.

BREED PRIZES

COMMEMORATIVE PEN FOR EVERY BREED

The HEART OF ILLINOIS CLUSTER SHOWS offers a Rosette for Best of Breed/Variety in every breed or variety of breed where the classes are a Supported Entry, unless otherwise offered.

SPORTING BREEDS

BRITTANYS

THE HEART OF ILLINOIS BRITTANY CLUB SUPPORTS THE ENTRY OF ITS BREED AT THIS SHOW

WORKING BREEDS

GREAT DANES

THE ILLINI GREAT DANE CLUB SUPPORTS THE ENTRY OF ITS BREED AT THIS SHOW.

The Illini Great Dane Club offers a 3-Streamer Rosette for Best of Breed, Best of Winners, Best of Opposite Sex to Best of Breed, Select Dog, Select Bitch, Winners Dog, Winners Bitch.

STANDARD SCHNAUZERS

THE PRAIRIELAND STANDARD SCHNAUZER CLUB OF CENTRAL ILLINOIS SUPPORTS THE ENTRY OF ITS BREED AT THIS SHOW.

The following prizes are offered by the Prairieland Standard Schnauzer Club of Central Illinois.

BEST OF BREED - Rosette & Garment Bag
BEST OF OPPOSITE SEX TO BEST OF BREED - Rosette & Garment Bag
BEST OWNER-HANDLED - Rosette & Garment Bag
SELECT DOG - Rosette & Garment Bag
SELECT BITCH - Rosette & Garment Bag
WINNERS DOG - Rosette & Garment Bag
WINNERS BITCH - Rosette & Garment Bag

TERRIER BREEDS

BULL TERRIERS (COLORED, WHITE)

The following prizes are offered by the Illiana Bull Terrier Fanciers
BEST OF VARIETY - Bull Terrier Figure
BEST OF OPPOSITE SEX TO BEST OF VARIETY - Bull Terrier Figure
WINNERS DOG - Bull Terrier Christmas Ornament
WINNERS BITCH - Bull Terrier Christmas Ornament

MINIATURE BULL TERRIERS

THE MINIATURE BULL TERRIER CLUB OF AMERICA SUPPORTS THE ENTRY OF ITS BREED AT THIS SHOW.

The following prizes will be Dog-themed Decor offered by Karen Toland for Best of Breed, Best of Opposite Sex to Best of Breed, Winners Dog, Reserve Winners Dog, Winners Bitch & Reserve Winners Bitch.

TOY BREEDS

PEKINGESE

THE NORTH CENTRAL ILLINOIS PEKINGESE CLUB SUPPORTS THE ENTRY OF ITS BREED AT THIS SHOW.

JUNIOR SHOWMANSHIP COMPETITION PRIZES

The members of the Corn Belt Kennel Club, Inc. are pleased to support the future education of the Juniors who participate in the Sport of Dogs. These juniors represent the future of our sport.

The Corn Belt Kennel Club, Inc. will offer a \$300.00 Scholarship Certificate for Best Junior Handler & \$200.00 Scholarship Certificate for Reserve Best Junior Handler chosen at this event* (not redeemable for cash).

These Scholarships are for one-time scholarship for post-secondary education (not necessarily a college). When the Junior enrolls, the Corn Belt Kennel Club, Inc. will require enrollment confirmation from the Juniors school of choice. The Corn Belt Kennel Club, Inc. will send payment directly to the school for credit to the junior's account.

Should the winning junior not redeem this certificate by age 25 years, the forfeited monies will be placed back into Corn Belt Kennel Club, Inc.'s Scholarship Fund for future use.

** Scholarship certificates will be awarded provided there is competition for this award. A minimum of 2 class winners must be present to compete for this award.*

BEST JUNIOR HANDLER - Large Rosette offered by the Corn Belt Kennel Club, Inc.

RESERVE BEST JUNIOR HANDLER - Large Rosette offered by the Corn Belt Kennel Club, Inc.



The following prizes are offered by the Junior Achievement Challenge.

FIRST IN EACH CLASS - 1 Group of AKC Breed Standards (Junior's Choice)

OFFICIAL AMERICAN KENNEL CLUB ENTRY FORM

BOTH SIDES OF ENTRY FORM MUST BE SUBMITTED • Appropriate Box(es) MUST BE CHECKED

Illinois Valley Kennel Club of Peoria, Inc.

Friday, May 22, 2026

Corn Belt Kennel Club, Inc.

Saturday, May 23, 2026

Illinois Valley Kennel Club of Peoria, Inc.

Sunday, May 24, 2026

Corn Belt Kennel Club, Inc.

Monday, May 25, 2026

4-6 Mo Beginner Puppy Competition - Saturday, May 23, 2026

4-6 Mo Beginner Puppy Competition - Sunday, May 24, 2026

See page 7 for entry fees

Interstate Center • 1106 Interstate Dr, Bloomington, Illinois 61705

ENTRIES CLOSE WEDNESDAY NOON, CDT MAY 6, 2026, or when the limit has been reached, if reached prior to this date, at Superintendent's Office. (See limit on page 6)

MAIL ENTRIES with Fees Payable to **JACK ONOFRIO**, PO Box 25764, Oklahoma City, OK 73125-0764.

NOTICE: PLEASE PUT BREED & NAME OF SHOW ON CHECKS. I ENCLOSE \$ _____ for entry fees.

IMPORTANT - Read Carefully instructions on reverse side before filling out. Numbers in the boxes indicate sections of the instructions relevant to the information needed in that box (PLEASE PRINT).

BREED	VARIETY (1)	SEX
--------------	--------------------	------------

DOG (2) (3) SHOW CLASS	CLASS (3) DIVISION Weight, Color, Etc.
-------------------------------	--

ADDITIONAL CLASSES	OBEDIENCE CLASS (Jump Height)	RALLY CLASS (Jump Height)	JR. SHOWMANSHIP CLASS
---------------------------	--------------------------------------	----------------------------------	------------------------------

NAME OF (See Back) JUNIOR HANDLER (if any)	JR. HANDLER AKC #
---	--------------------------

FULL NAME OF DOG	DATE OF BIRTH
-------------------------	----------------------

<input type="checkbox"/> AKC® NO.	Enter number here
<input type="checkbox"/> PAL NO.	
<input type="checkbox"/> FOREIGN REG. NO. & COUNTRY	
Do not print the above in the catalog	

BREEDER _____

SIRE _____

DAM _____

Exhibitor's Code _____

ACTUAL OWNER(S) [4] _____
(Please Print)

OWNER'S ADDRESS _____

CITY _____ **STATE** _____ **ZIP + 4** _____

NAME OF OWNER'S AGENT (IF ANY) AT THIS SHOW _____ **CODE #** _____

I CERTIFY that I am the actual owner of the dog, or that I am the duly authorized agent of the actual owner whose name I have entered above. In consideration of the acceptance of this entry, I (we) agree to abide by the rules and regulations of the American Kennel Club in effect at the time of this event, and by any additional rules and regulations appearing in the premium list for this event, and further agree to be bound by the "Agreement" printed on the reverse side of this entry form. I (we) certify and represent that the dog entered is not a hazard to persons or other dogs. This entry is submitted for acceptance on the foregoing representation and Agreement. I (we) agree to conduct myself (ourselves) in accordance with all such Rules and Regulations (including all provisions applying to discipline) and to abide by any decisions made in accord with them.

■ SIGNATURE of owner or his agent
duly authorized to make this entry _____

Telephone () _____

ARE YOU A NEW EXHIBITOR? Yes No **OWNER-HANDLED ELIGIBLE?** Yes No

Email address: _____

(An acknowledgement or receipt of entry may be sent to this email address)

CHECK THIS BOX TO RECEIVE A PRINTED JUDGING PROGRAM

Emergency Contact: _____ **Telephone ()** _____

AGREEMENT

I (we) agree that the club holding this event has the right to refuse this entry for cause which the club shall deem sufficient. In consideration of the acceptance of this entry and of the holding of this event and of the opportunity to have the dog judged and to win prizes, ribbons, or trophies, I (we) agree to hold the AKC, the event-giving club, their members, directors, governors, officers, agents, superintendents or event secretary and the owner and/or lessor of the premises and any provider of services that are necessary to hold this event and any employees or volunteers of the aforementioned parties, and any AKC approved judge, judging at this event, harmless from any claim for loss or injury which may be alleged to have been caused directly or indirectly to any person or thing by the act of this dog while in or about the event premises or grounds or near any entrance thereto, and I (we) personally assume all responsibility and liability for any such claim; and I (we) further agree to hold the aforementioned parties harmless from any claim for loss, injury or damage to this dog. Additionally, I (we) hereby assume the sole responsibility for and agree to indemnify, defend and save the aforementioned parties harmless from any and all loss and expense (including legal fees) by reason of the liability imposed by law upon any of the aforementioned parties for damage because of bodily injuries, including death at any time resulting therefrom, sustained by any person or persons, including myself (ourselves), or on account of damage to property, arising out of or in consequence of my (our) participation in this event, however such, injuries, death or property damage may be caused, and whether or not the same may have been caused or may be alleged to have been caused by the negligence of the aforementioned parties or any of their employees, agents, or any other persons. **I (WE) AGREE THAT ANY CAUSE OF ACTION, CONTROVERSY OR CLAIM ARISING OUT OF OR RELATED TO THE ENTRY, EXHIBITION OR ATTENDANCE AT THE EVENT BETWEEN THE AKC AND THE EVENT-GIVING CLUB (UNLESS OTHERWISE STATED IN ITS PREMIUM LIST) AND MYSELF (OURSELVES) OR AS TO THE CONSTRUCTION, INTERPRETATION AND EFFECT OF THIS AGREEMENT SHALL BE SETTLED BY ARBITRATION PURSUANT TO THE APPLICABLE RULES OF THE AMERICAN ARBITRATION ASSOCIATION. HOWEVER, PRIOR TO ARBITRATION ALL APPLICABLE AKC BYLAWS, RULES, REGULATIONS AND PROCEDURES MUST FIRST BE FOLLOWED AS SET FORTH IN THE AKC CHARTER AND BYLAWS, RULES, REGULATIONS, PUBLISHED POLICIES AND GUIDELINES.**

INSTRUCTIONS

- (Variety) if you are entering a dog of breed in which there are varieties for show purposes, please designate the particular variety you are entering i.e., Cocker Spaniel (solid color black, ASCOB, parti-color), Beagles (not exceeding 13 in. over 13 in. but not exceeding 15 in.), Dachshunds (longhaired, smooth, wirehaired), Bull Terriers (colored, white), Manchester Terriers (standard, toy), Chihuahuas (smooth coat, long coat), English Toy Spaniels (King Charles and Ruby, Blenheim and Prince Charles), Poodles (toy, miniature, standard), Collies (rough, smooth),
- The following categories of dogs may be entered and shown in Best of Breed competition: Dogs that are Champions of Record and dogs which, according to their owner's records, have completed the requirements for a championship, but whose championships are unconfirmed. The showing of unconfirmed Champions in Best of Breed competition is limited to a period of 90 days from the date of the show where the dog completed the requirements for a championship.
- (Event Class) Consult the classification in this premium list. If the event class in which you are entering your dog is divided, then, in addition to designating the class, specify the particular division of the class in which you are entering your dog, i.e., age division, color division, weight division.
- A dog must be entered in the name of the person who actually owned it at the time entries for an event closed. If a registered dog has been acquired by a new owner, it must be entered in the name of its new owner in any event for which entries closed after the date of acquirement, regardless of whether the new owner has received the registration certificate indicating that the dog is recorded in his name. State on entry form whether transfer application has been mailed to the AKC (For complete rules refer to Chapter 11, Section 3).
- Mixed Breed dogs entering classes for Agility, Obedience and Rally trials should mark Breed as AKC Canine Partners Listed Dog "All-American Dog/Mixed Breed." Sire and Dam information shall remain blank for mixed breed entrants.

If this entry is for Jr Showmanship, please enter the following information:

JUNIOR SHOWMANSHIP

JR.'S DATE OF BIRTH _____

AKC JR HANDLER NUMBER _____

The above number **MUST** be included. Should you not have your Junior Handler number, this may be obtained from the AMERICAN KENNEL CLUB. PHONE:(919) 233-9767.

By signing the entry form I (we) certify that the Junior Showman does not now, and will not at any time, act as an agent/handler for pay while continuing to compete in Junior Showmanship.

ADDRESS

City

State

ZIP

OFFICIAL AMERICAN KENNEL CLUB ENTRY FORM

BOTH SIDES OF ENTRY FORM MUST BE SUBMITTED • Appropriate Box(es) MUST BE CHECKED

CONCURRENT SPECIALTIES

CHICAGO BULLDOG CLUB, INC.

Saturday, May 23, 2026

Sunday, May 24, 2026

See page 7 for entry fees

Interstate Center • 1106 Interstate Dr, Bloomington, Illinois 61705

ENTRIES CLOSE WEDNESDAY NOON, CDT MAY 6, 2026, or when the limit has been reached, if reached prior to this date, at Secretary's Office. (See limit on page 6)

MAIL ENTRIES with Fees Payable to JACK ONOFRIO, PO Box 25764, Oklahoma City, OK 73125-0764.

NOTICE: PLEASE PUT BREED & NAME OF SHOW ON CHECKS. I ENCLOSE \$ _____ for entry fees.

IMPORTANT - Read Carefully instructions on reverse side before filling out. Numbers in the boxes indicate sections of the instructions relevant to the information needed in that box (PLEASE PRINT).

BREED		VARIETY (1)		SEX
DOG (2) (3) SHOW CLASS			CLASS (3) DIVISION Weight, Color, Etc.	
ADDITIONAL CLASSES	OBEDIENCE CLASS (Jump Height)	RALLY CLASS (Jump Height)	JR. SHOWMANSHIP CLASS	
NAME OF (See Back) JUNIOR HANDLER (if any)			JR. HANDLER AKC #	
FULL NAME OF DOG				
			Enter number here	DATE OF BIRTH
<input type="checkbox"/> AKC® NO.			PLACE OF BIRTH (list country)	
<input type="checkbox"/> PAL NO.			Do not print the above in the catalog	
<input type="checkbox"/> FOREIGN REG. NO. & COUNTRY				
BREEDER				
SIRE				
DAM				
Exhibitor's Code _____				
ACTUAL OWNER(S) [4] _____ (Please Print)				
OWNER'S ADDRESS _____				
CITY _____ STATE _____ ZIP + 4 _____				
NAME OF OWNER'S AGENT (IF ANY) AT THIS SHOW				CODE #

I CERTIFY that I am the actual owner of the dog, or that I am the duly authorized agent of the actual owner whose name I have entered above. In consideration of the acceptance of this entry, I (we) agree to abide by the rules and regulations of the American Kennel Club in effect at the time of this event, and by any additional rules and regulations appearing in the premium list for this event, and further agree to be bound by the "Agreement" printed on the reverse side of this entry form. I (we) certify and represent that the dog entered is not a hazard to persons or other dogs. This entry is submitted for acceptance on the foregoing representation and Agreement. I (we) agree to conduct myself (ourselves) in accordance with all such Rules and Regulations (including all provisions applying to discipline) and to abide by any decisions made in accord with them.

SIGNATURE of owner or his agent
duly authorized to make this entry _____

Telephone () _____

ARE YOU A NEW EXHIBITOR? Yes No

Email address: _____

(An acknowledgement or receipt of entry may be sent to this email address)

CHECK THIS BOX TO RECEIVE A PRINTED JUDGING PROGRAM

Emergency Contact: _____ Telephone () _____

AGREEMENT

I (we) agree that the club holding this event has the right to refuse this entry for cause which the club shall deem sufficient. In consideration of the acceptance of this entry and of the holding of this event and of the opportunity to have the dog judged and to win prizes, ribbons, or trophies, I (we) agree to hold the AKC, the event-giving club, their members, directors, governors, officers, agents, superintendents or event secretary and the owner and/or lessor of the premises and any provider of services that are necessary to hold this event and any employees or volunteers of the aforementioned parties, and any AKC approved judge, judging at this event, harmless from any claim for loss or injury which may be alleged to have been caused directly or indirectly to any person or thing by the act of this dog while in or about the event premises or grounds or near any entrance thereto, and I (we) personally assume all responsibility and liability for any such claim; and I (we) further agree to hold the aforementioned parties harmless from any claim for loss, injury or damage to this dog. Additionally, I (we) hereby assume the sole responsibility for and agree to indemnify, defend and save the aforementioned parties harmless from any and all loss and expense (including legal fees) by reason of the liability imposed by law upon any of the aforementioned parties for damage because of bodily injuries, including death at any time resulting therefrom, sustained by any person or persons, including myself (ourselves), or on account of damage to property, arising out of or in consequence of my (our) participation in this event, however such, injuries, death or property damage may be caused, and whether or not the same may have been caused or may be alleged to have been caused by the negligence of the aforementioned parties or any of their employees, agents, or any other persons. **I (WE) AGREE THAT ANY CAUSE OF ACTION, CONTROVERSY OR CLAIM ARISING OUT OF OR RELATED TO THE ENTRY, EXHIBITION OR ATTENDANCE AT THE EVENT BETWEEN THE AKC AND THE EVENT-GIVING CLUB (UNLESS OTHERWISE STATED IN ITS PREMIUM LIST) AND MYSELF (OURSELVES) OR AS TO THE CONSTRUCTION, INTERPRETATION AND EFFECT OF THIS AGREEMENT SHALL BE SETTLED BY ARBITRATION PURSUANT TO THE APPLICABLE RULES OF THE AMERICAN ARBITRATION ASSOCIATION. HOWEVER, PRIOR TO ARBITRATION ALL APPLICABLE AKC BYLAWS, RULES, REGULATIONS AND PROCEDURES MUST FIRST BE FOLLOWED AS SET FORTH IN THE AKC CHARTER AND BYLAWS, RULES, REGULATIONS, PUBLISHED POLICIES AND GUIDELINES.**

INSTRUCTIONS

- (Variety) if you are entering a dog of breed in which there are varieties for show purposes, please designate the particular variety you are entering i.e., Cocker Spaniel (solid color black, ASCOB, parti-color), Beagles (not exceeding 13 in. over 13 in. but not exceeding 15 in.), Dachshunds (longhaired, smooth, wirehaired), Bull Terriers (colored, white), Manchester Terriers (standard, toy), Chihuahuas (smooth coat, long coat), English Toy Spaniels (King Charles and Ruby, Blenheim and Prince Charles), Poodles (toy, miniature, standard), Collies (rough, smooth),
- The following categories of dogs may be entered and shown in Best of Breed competition: Dogs that are Champions of Record and dogs which, according to their owner's records, have completed the requirements for a championship, but whose championships are unconfirmed. The showing of unconfirmed Champions in Best of Breed competition is limited to a period of 90 days from the date of the show where the dog completed the requirements for a championship.
- (Event Class) Consult the classification in this premium list. If the event class in which you are entering your dog is divided, then, in addition to designating the class, specify the particular division of the class in which you are entering your dog, i.e., age division, color division, weight division.
- A dog must be entered in the name of the person who actually owned it at the time entries for an event closed. If a registered dog has been acquired by a new owner, it must be entered in the name of its new owner in any event for which entries closed after the date of acquirement, regardless of whether the new owner has received the registration certificate indicating that the dog is recorded in his name. State on entry form whether transfer application has been mailed to the AKC (For complete rules refer to Chapter 11, Section 3).
- Mixed Breed dogs entering classes for Agility, Obedience and Rally trials should mark Breed as AKC Canine Partners Listed Dog "All-American Dog/Mixed Breed." Sire and Dam information shall remain blank for mixed breed entrants.

If this entry is for Jr Showmanship, please enter the following information:

JUNIOR SHOWMANSHIP

JR.'S DATE OF BIRTH _____

AKC JR HANDLER NUMBER _____

The above number **MUST** be included. Should you not have your Junior Handler number, this may be obtained from the AMERICAN KENNEL CLUB. PHONE:(919) 233-9767.

By signing the entry form I (we) certify that the Junior Showman does not now, and will not at any time, act as an agent/handler for pay while continuing to compete in Junior Showmanship.

ADDRESS

City

State

ZIP